



# CUSTOM

## OPEN BASE CHEF STAND MODEL 21000

Open shelving cooking equipment stand with reinforced stainless steel equipment shelf. Integral backsplash with 45° return. Reinforced stainless steel storage shelf. 6" high adjustable and movable legs.

PROJECT NAME:

LOCATION:

ITEM NO:

QTY:

MODEL NO:

AIA NO:

SIS NO:

CSI SECTION: 11400

### AVAILABLE MODELS:

- 21348
- 21360
- 21372
- 21384
- 21396
- 213108
- 213120

### STANDARD FEATURES:

- Available under one piece top with other modular equipment up to 16' in length
- 6" high legs—adjustable and movable
- 10" wide x 1 1/4" thick laminated maple work board
- If unit is fitted with vent, then backsplash will be 3" thick to meet NFPA 96
- 45° integral stainless backsplash is standard. 90° stainless backsplash is optional.

**EQUIPMENT SHELF:** Equipment shelf to be one piece of die-formed stainless steel with 2" nosing and marine edge. Shelf is reinforced with welded channel brace assembly.

**UNIT BODY:** Body ends to be die formed stainless steel, finished and polished on the inside, with corrosion resistant exterior. Ends at top fitted with recessed heavy duty steel bars for splining units together, producing a hairline seam. Backsplash to be covered cornered, with 45° return at top and overall height of 6 3/4". (If fitted with vent system, standard backsplash to be omitted and unit fitted with 3" thick backsplash to meet NFPA 96). 10" wide x 1 1/4" thick laminated maple cutting board provided with removable supports. Bottom shelf to be 22 gauge stainless steel with marine edge at front, 6 5/8" removable covered cornered turn up at rear, and integrally welded channel bracing. Legs to be 6" high stainless steel with adjustable bullet foot. Legs mounted to full length channel frame assembly which is integrally welded to bottom of assembly. Legs can be moved left to right to avoid floor obstacles during installation.

**ORIGIN OF MANUFACTURE:** Designed and manufactured in the United States.

Custom, Open Base Chef Stand.  
Model shown with optional finished end.



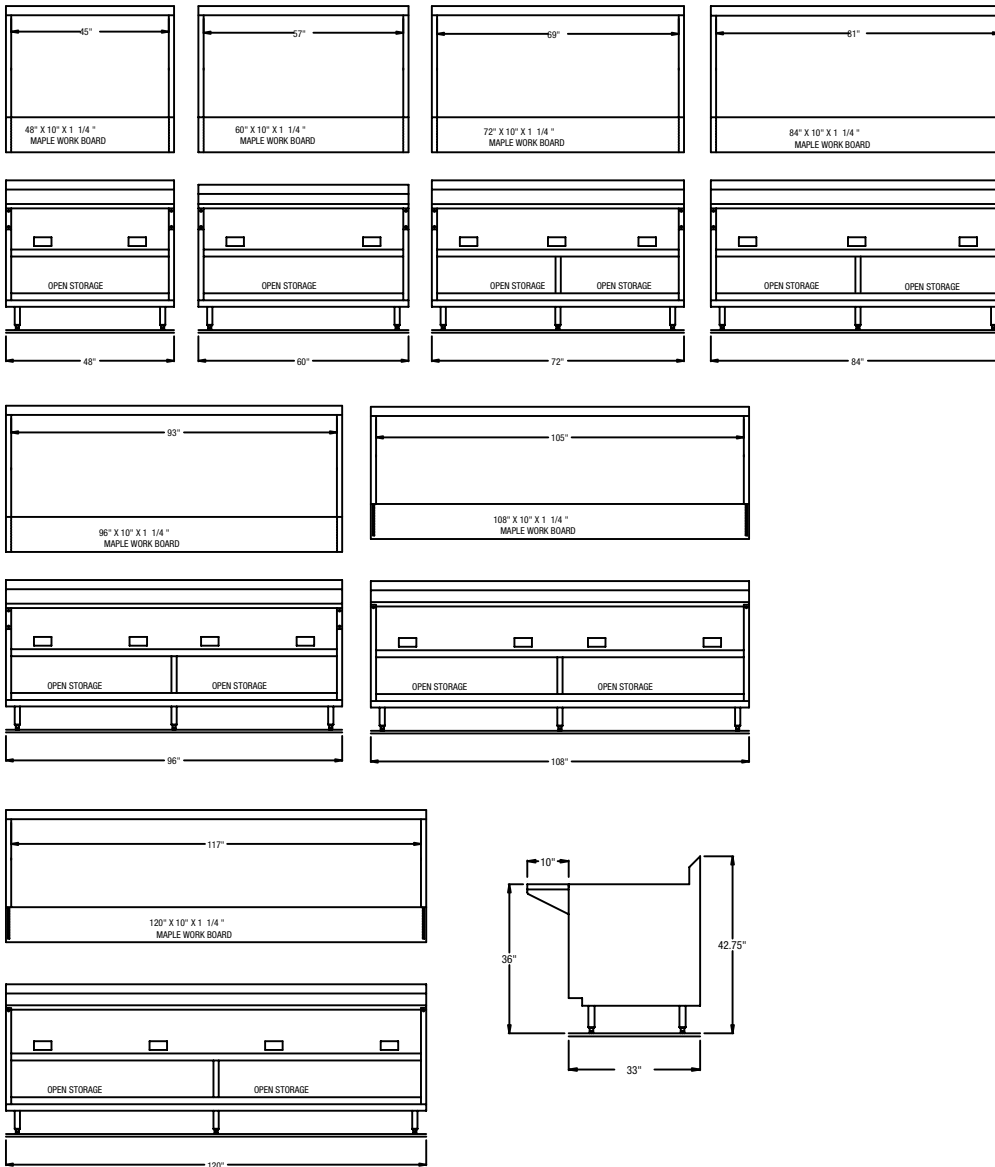

29" Deep							
<b>Length</b>	48"	60"	72"	84"	96"	108"	120"
<b>Height*</b>	36"	36"	36"	36"	36"	36"	36"
<b>Ship Wt. (lbs)</b>	254	296	345	393	437	476	520
33" Deep							
<b>Length</b>	48"	60"	72"	84"	96"	108"	120"
<b>Model No.</b>	21348	21360	21372	21384	21396	21608	21620
<b>Height*</b>	36"	36"	36"	36"	36"	36"	36"
<b>Ship Wt. (lbs)</b>	254	296	345	393	437	476	520

- Top shelf depth is 25" deep on 29" deep equipment.
- Bottom shelf depth is 23 1/8" deep on 29" deep equipment.
- Top shelf depth is 29" deep on 33" deep equipment.
- Bottom shelf depth is 23 1/8" deep on 33" deep equipment.
- Inside clearance = total unit length less 3".

\* All models with adjustable and movable legs for 35 1/2" to 36 3/4" work height.