



PREPARATION TABLE

REAR-COMPRESSOR FOOD PREP TABLE MODEL 9000-7

Range from 27" to 60" long models, with a work surface height of 36". The models 9412-32-7 and 9412-32D-7 are 32.75" deep, while the others are 30" deep. Self-contained refrigerated salad top unit with back-mounted removable, replaceable, R-134a refrigeration system. "Front Breathing" system, requiring no side or back clearance. Top openings include sanitary raised rims and recessed adaptor to hold several 1/6 size pans.

PROJECT NAME:

LOCATION:

ITEM NO:

QTY:

MODEL NO:

AIA NO:

SIS NO:

CSI SECTION: 11400

AVAILABLE MODELS:

- 9401-7 27" 6-pan with door
- 9412-32-7 32" 12-pan with door
- 9412-32D-7 32" 12-pan with drawers
- 9801-7 36" 8-pan with doors
- 9303-7 48" 8-pan with doors
- 9304-7 48" 10-pan with doors
- 9305-7 48" 12-pan with doors
- 9601-7 60" 14-pan with doors

STANDARD FEATURES:

- Self-contained, removable, replaceable refrigeration package that utilizes "CFC free" R-134a refrigerant
- Front Breathing / Down-Draft refrigeration system
- Stainless steel cover removable without tools
- Fully adjustable shelves behind self-closing doors (model 9412-32D-7 has (2)drawers in lieu of door)
- Full length NSF approved composition cutting board
- Stainless steel top, sides, and front
- Hot gas Condensate evaporator

CABINET EXTERIOR: Constructed of all metal. The top, sides, and front are stainless steel. Cabinet top to be one piece die-formed 20 gauge stainless steel with 1 1/2" high square nosing. Top opening with raised rims and recessed adaptor to hold up to 6" deep pans. Fully assembled and installed stainless steel cover which also provides shelf for light duty storage of items. Bottom & back of unit are corrosion resistant steel. Full length NSF cutting board provided. Door openings to be ABS and to contain magnetic strip for positive sealing of gaskets. Model 9412-32D-7 comes with (2) refrigerated drawers, each opening frame to be stainless steel with ABS breaker strips. Drawer fronts to be 24 gauge stainless steel with 16 gauge stainless handle, magnetic gasket, ABS interior liner and foamed in place insulation. Units ship standard on (4) 6" legs, except for models 9412-32-7 & 9412-32D-7 which ship standard on 2 1/2" high casters.

CABINET INTERIOR: Fully coved to meet N.S.F. standard #7. The interior bottom, back, and top are anodized aluminum with coved corners for easy clean-up. The interior ends are ABS. Unit insulated with a minimum of 2.5" of CFC free, foamed in place polyurethane. (Model 9412-32D-7 with two refrigerated drawers below top. Each drawer contains two 12" x 20" x 6" deep polycarbonate pans- pans are removable without removing drawer tracks. Drawer tracks are 14 gauge stainless steel with 1 5/16" stainless steel ball bearings, self-closing and removable without tools).

DOORS: Stainless steel front with easy to grasp recessed handles, mounted on heavy duty concealed hinges. Hinges are all stainless steel with bronze pivot pin in nylon bushing, spring loaded to be self-closing. Door with foamed in place insulation, press fit magnetic gaskets - (designed for installation & removal without tools), and deep draw ABS interior liner for maximum insulation value. (Model 9412-32D-7, has refrigerated drawers in lieu of door).

REFRIGERATION: CFC free, R-134a back mounted refrigeration system to be self-contained with evaporator blower coil, compressor, thermostatic control, forced-air condensing coil and capillary tube contained in removable assembly. Condensate evaporator provided. Units totally prewired and to be supplied with 8' cordset(NEMA 5-15P) for 115 V operation. "Front Breathing" refrigeration system, requires no side or back clearance.

This equipment is intended for use in rooms having an ambient temperature of 86°F (30°C) or less.

ORIGIN OF MANUFACTURE: Designed and manufactured in the United States.

Model 9412-32D-7 shown.



OPTIONS/ACCESSORIES:

- Stainless steel back panel
- Overshelves (double or single tier)
- Backsplash
- Casters
- Drawers in lieu of doors

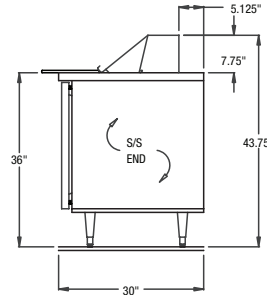
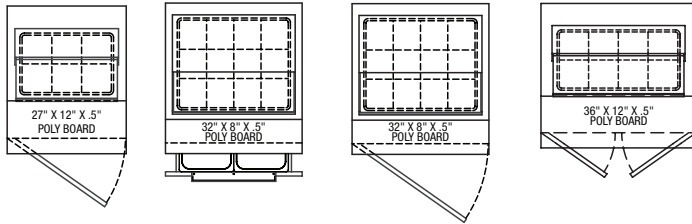

Side-View for Models:

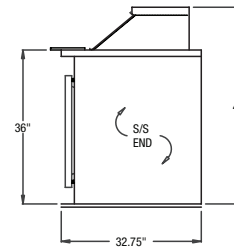
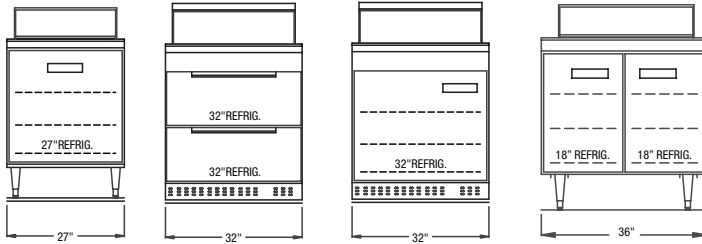
 9401-7
 9801-7
 9303-7
 9304-7
 9305-7
 9601-7

Side-View for Models:

 9412-32-7
 9412-32D-7

9401-7

9412-32D-7

9412-32-7

9801-7

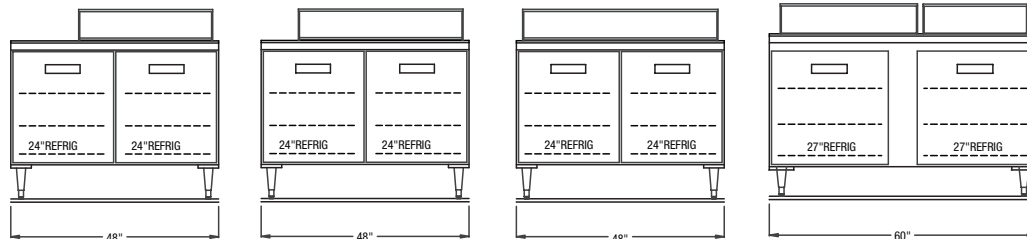
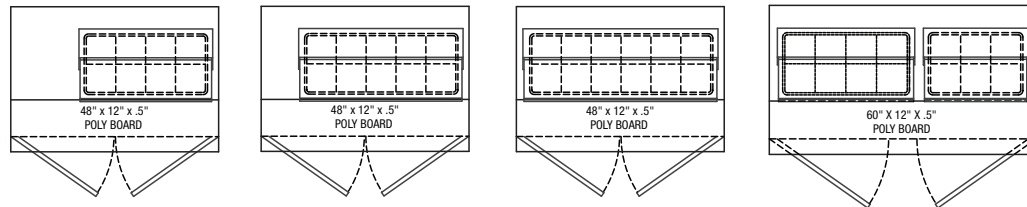

9303-7

9304-7

9305-7

9601-7

NOTE: When ordering casters, 6" casters equal 35" height; 4" casters equal 33" height

Model	L	W	H	Doors	Storage Cu. Ft.	Top Pan Capacity	HP	Volt	Amps	NEMA	Ship Wt.
9401-7	27"	30"	36"	(1) 27"	5.66	(6) 1/6	1/4	115/60/1	5.5	5-15P	175
9412-32D-7	32"	32.75"	36"	(2) 32" drawers	each drawer accommodates (2) 12"x20" pans	(2) 12"x20" that hold (12) 1/6 pans	1/4	115/60/1	5.5	5-15P	300
9412-32-7	32"	32.75"	36"	(1) 32"	8.62	(2) 12"x20" that hold (12) 1/6 pans	1/4	115/60/1	5.5	5-15P	252
9801-7	36"	30"	36"	(2) 18"	7.87	(8) 1/6	1/4	115/60/1	5.5	5-15P	245
9303-7	48"	30"	36"	(2) 24"	10.82	(8) 1/6	1/4	115/60/1	5.5	5-15P	280
9304-7	48"	30"	36"	(2) 24"	10.82	(10) 1/6	1/4	115/60/1	5.5	5-15P	280
9305-7	48"	30"	36"	(2) 24"	10.82	(12) 1/6	1/4	115/60/1	5.5	5-15P	280
9601-7	60"	30"	36"	(2) 27"	13.77	(14) 1/6	1/4	115/60/1	5.5	5-15P	300