



CAPKOLD® COOK-CHILL SYSTEMS

MID VOLUME PUMP STATION MODEL CKSP-64

CapKold® Model CKSP-64 pump fill station is designed to pump a wide range of liquid or semi-liquid food products into plastic casings, pans or other containers.

STANDARD FEATURES:

- All Stainless steel single piston pump station
- 16-64 ounce per stroke piston and cylinder set
- Stroke adjustment counter for easy fill size setting
- Tool-free disassembly for rapid sanitizing
- Pneumatic filter/oiler/regulator
- Non-marking locking swivel casters
- 1-½" diameter stainless steel discharge line
- 1-½" vertical positive shut-off spout assembly
- Pouch platform to support the pouches
- All air actuated. No power required for pump
- Manufactured to the latest sanitary standards and HACCP compliant
- All stainless steel outlet piping
- Positive cut off nozzle for filling
- Manual height adjustment
- Unique tilt mechanism allows for easy switching between kettles
- Foot pedal operation for filling

CONTROLS:

- Foot switch controls the pumping action
- Stroke adjustment counter can be set for the number of strokes required
- Piston stroke distance can be easily adjusted for accurately changing portion sizes
- Easy dispensing nozzle height adjustment

ORIGIN OF MANUFACTURE: Designed and manufactured in the United States.

PROJECT NAME:

LOCATION:

ITEM NO:

QTY:

MODEL NO:

AIA NO:

SIS NO:

CKSP-64 pump station, shown with optional heat sealing unit



OPTIONS/ACCESSORIES:

- Spare parts kit
- Manual clipper
- Air actuated clipper
- Heat sealing unit

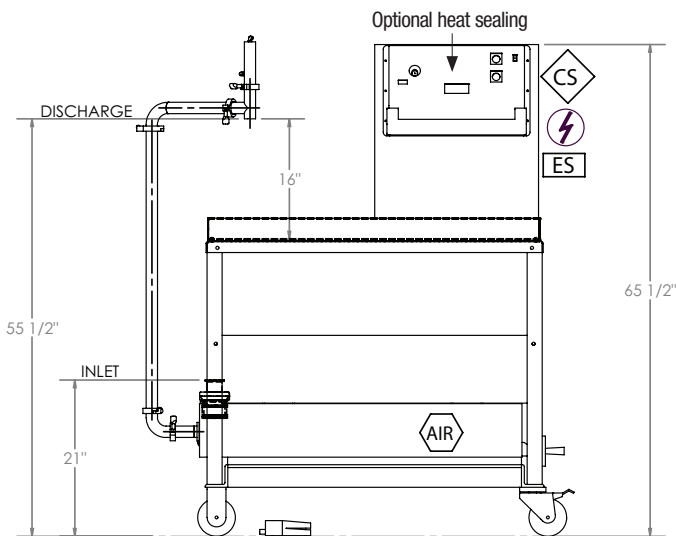
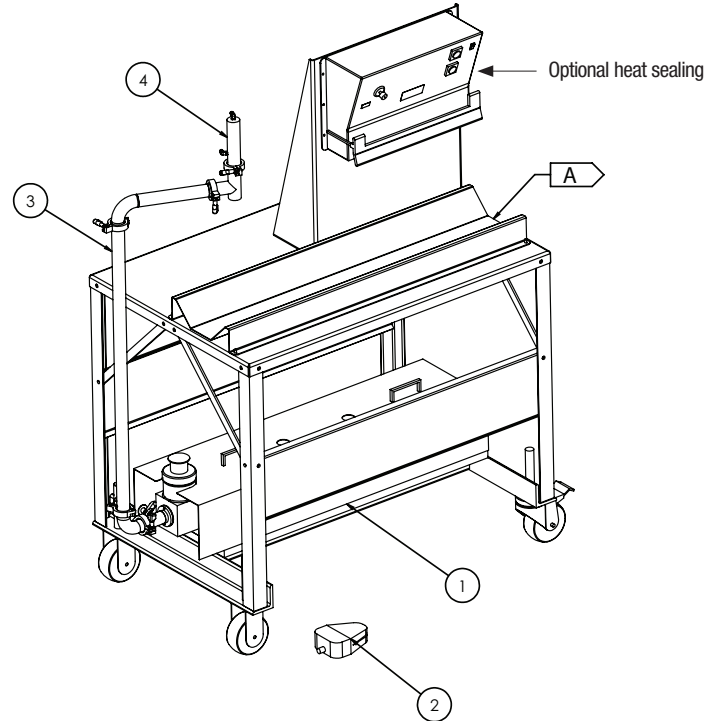
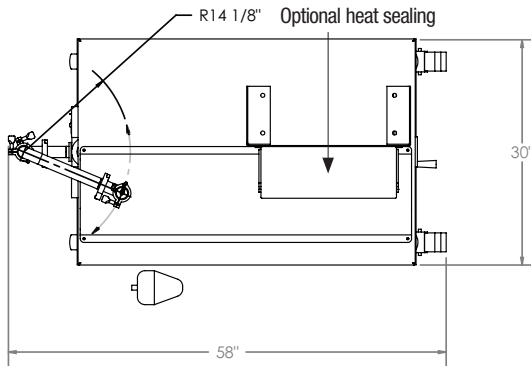

ITEM NO.	EQUIPMENT PROVIDED BY HINDS-BOCK	QTY
1	SP-64 PUMP FILLER	1
2	FOOT SWITCH, AIR	1
3	DISCHARGE PIPE, 1-1/2"	1
4	CUT-OFF SPOUT, 1-1/2"	1

NOTES:

ALL DIMENSIONS ARE FOR REFERENCE ONLY.

SCFM: TO BE DETERMINED @ 90 PSI

MAXIMUM ALLOWABLE PRESSURE DROP: 10 PSI

POUCH SUPPORT PLATFORM

A

LEGEND

ES E-STOP

AIR AIR DROP: 1/2" NPT

⚡ POWER DROP

CS CONTROL STATION

