



# CHINOOK VALUE VENTILATION

## EXHAUST ONLY FILTER MODEL VDW

The Avtec model VDW is an exhaust only condensate canopy designed to ventilate steam producing cooking equipment. This model hood is recommended to be installed over automatic dishwashers and steam or heat producing cooking equipment this hood is for use in Type II applications only.

**SHORT FORM SPEC:** The Avtec model VDW hood is a wall mount canopy. The VDW is designed for use over dish washers as well as other Type II hood applications over suitable equipment. The VDW includes a perimeter gutter with drain and drip screen.

### STANDARD FEATURES:

- All 300 series stainless steel construction
- Hanging brackets
- Perimeter gutter with drain
- Perforated stainless steel duct protector

**SPECIFICATIONS:** This is a single shell exhaust only Type II canopy. Hood shall be constructed of all stainless steel. Hood shall have a 2" wide perimeter gutter with a 1/2" diameter drain located in one corner and a 3" stainless steel nipple. Hood shall also contain a stainless steel perforated duct protector.

**ORIGIN OF MANUFACTURE:** Designed and manufactured in the United States.

Certifications: 

PROJECT NAME:	
LOCATION:	
ITEM NO:	
QTY:	
MODEL NO:	
AIA NO:	
SIS NO:	
CSI SECTION:	11400

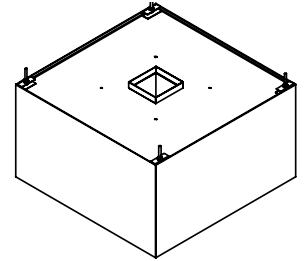

Model VDW shown

### OPTIONS/ACCESSORIES:

- UL Listed incandescent globe lights
- Stainless steel top enclosures
- Light switch
- Light and fan switch
- Stainless steel wall panel

### ADDITIONAL RESOURCES:

- [Request A Quote](#)
- [Product Videos](#)
- [Sales Tools](#)
- [Find A Rep](#)

**Chinook Value Ventilation**  
**PP SPEC1031 RevD**

HANGER BRACKET

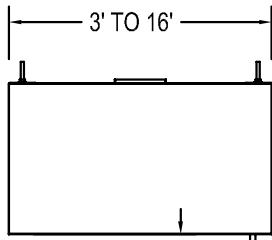
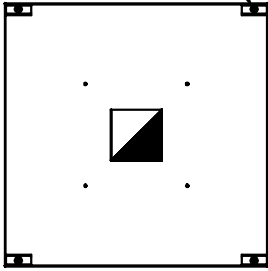

3"

0.500" THREADED DRAIN  
LOCATED ON RIGHT SIDE

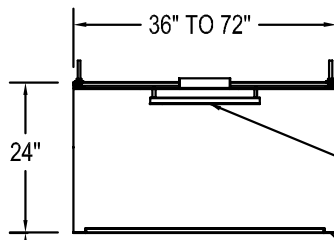

24"

78  
AFF  
TYP.

REMOVABLE PERFORATED  
S/S DUCT SCREEN

2" PERIMETER GUTTER

Hood size is based on make and model of equipment that it goes above. Consult factory for specific exhaust CFM and collar size.