



# CUSTOM

## DRAWER BASE UTILITY STAND MODEL 12000

Drawer base utility stand with 16 gauge reinforced stainless top, and integral backsplash with 45° return. Self-closing dry storage drawers on 16 gauge tracks with 1 5/8" stainless bearings and removable plastic pans. 6" high adjustable and movable legs.

PROJECT NAME:

LOCATION:

ITEM NO:

QTY:

MODEL NO:

AIA NO:

SIS NO:

CSI SECTION: 11400

### AVAILABLE MODELS:

- 12318
- 12324
- 12336
- 12348
- 12360
- 12372

### STANDARD FEATURES:

- Available under one piece top with other modular equipment up to 16' in length
- 6" high legs—adjustable and movable
- Removable plastic pan(s) supplied for each self-closing drawer
- 45° integral stainless backsplash is standard. 90° stainless backsplash is optional.

**UNIT TOP:** Top to be one piece of die formed 16 gauge stainless steel with 2 1/2" nosing. Backsplash to be covered cornered, with 45° return at top and overall height of 6 3/4". Ends at top fitted with recessed heavy duty steel bars for field bolting units together, producing a hairline seam. Top reinforced with (2) full length channel braces.

**UNIT BODY:** Body ends to be die formed stainless steel, finished and polished on the inside, with corrosion resistant exterior. Shelf to be 22 gauge stainless steel with marine edge at front, 6 5/8" removable covered cornered turn up at rear, and integrally welded channel bracing. Dry storage drawer(s) are located below shelf. Drawer pans are plastic, removable without tools, with drawer track of 16 gauge stainless steel with 1 5/8" stainless steel bearings, self-closing. Drawer front of 22 gauge stainless steel. Drawer track, pan(s) and front assembly contained in 20 gauge stainless steel housing. Legs to be 6" high stainless steel with adjustable bullet foot. Legs mounted to full length channel frame assembly which is integrally welded to bottom of body assembly. Legs can be moved left to right to avoid floor obstacles during installation.

**NOTE:** Multiple units may be built under a common top to get to longer lengths.

**ORIGIN OF MANUFACTURE:** Designed and manufactured in the United States.

Custom, Drawer Base Utility Stand. Model shown with optional finished end.



### OPTIONS/ACCESSORIES:

- Additional drawers
- Urn trough
- Depth modification
- Casters

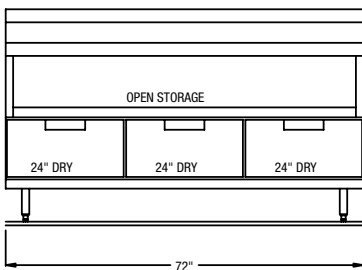
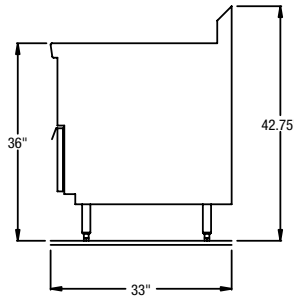
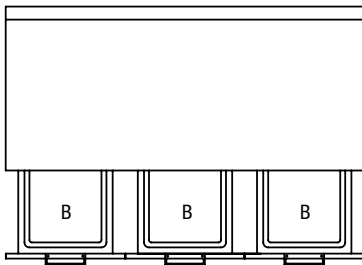

29" Deep						
<b>Length</b>	18"	24"	36"	48"	60"	72"
<b>Height*</b>	36"	36"	36"	36"	36"	36"
<b>Drawers</b>	(1) 18"	(1) 24"	(2) 18"	(2) 24"	(2) 18" (1) 24"	(3) 24"
<b>Ship Wt. (lbs)</b>	152	180	236	285	334	384
33" Deep						
<b>Length</b>	18"	24"	36"	48"	60"	72"
<b>Model No.</b>	12318	12324	12336	12348	12360	12372
<b>Height*</b>	36"	36"	36"	36"	36"	36"
<b>Drawers</b>	(1) 18"	(1) 24"	(2) 18"	(2) 24"	(2) 18" (1) 24"	(3) 24"
<b>Ship Wt. (lbs)</b>	152	180	236	285	334	384

ABS DRAWER PANS	
Drawer Size	Removable Pan Size
A 18"	11" x 16" x 6"
B 24"	16" x 16" x 6"