



CUSTOM

DRY CHEF STAND MODEL 22000

Open shelving cooking equipment stand with reinforced stainless steel equipment shelf. Integral backsplash with 45° return. Dry storage drawers on 16 gauge tracks with 1 5/8" stainless bearings and removable plastic pan. 6" high adjustable and movable legs.

PROJECT NAME:

LOCATION:

ITEM NO:

QTY:

MODEL NO:

AIA NO:

SIS NO:

CSI SECTION: 11400

AVAILABLE MODELS:

- 22348
- 22360
- 22372
- 22384
- 22396
- 223108
- 223120

STANDARD FEATURES:

- Available under one piece top with other modular equipment up to 16' in length
- 6" high legs—adjustable and movable
- 10 3/8" wide x 1 1/4" thick laminated maple work board
- If unit is fitted with vent, then backsplash will be 3" thick to meet NFPA 96
- Removable plastic pan supplied for each self-closing drawer
- 45° integral stainless backsplash is standard. 90° stainless backsplash is optional.
- Equipment Rails are optional

EQUIPMENT SHELF: Equipment shelf to be one piece of die-formed stainless steel with 2" nosing and marine edge. Shelf is reinforced with welded channel brace assembly.

UNIT BODY: Body ends to be die-formed stainless steel, finished and polished on the inside, with corrosion resistant steel exterior. Ends at top fitted with recessed heavy duty steel bars for splining units together, producing a hairline seam. Backsplash to be coved cornered, with 45° return at top and overall height of 6 3/4". (If fitted with vent system, standard backsplash to be omitted and unit fitted with 3" thick backsplash to meet NFPA 96). 10 3/8" wide x 1 1/4" thick laminated maple cutting board provided with removable supports. Dry storage drawers are located below equipment shelf. Drawer pans are plastic, removable without tools, with drawer track of 16 gauge stainless steel with 1 5/8" stainless steel bearings, self-closing. Drawer front of 22 gauge stainless steel. Drawer track, pans and front assembly contained in 20 gauge steel housing. Legs to be 6" high stainless steel, with adjustable bullet foot. Legs mounted to full length channel frame assembly which is integrally welded to bottom of assembly. Legs can be moved left to right to avoid floor obstacles during installation.

ORIGIN OF MANUFACTURE: Designed and manufactured in the United States.

Custom, Dry Chef Stand. Model shown with optional finished end.



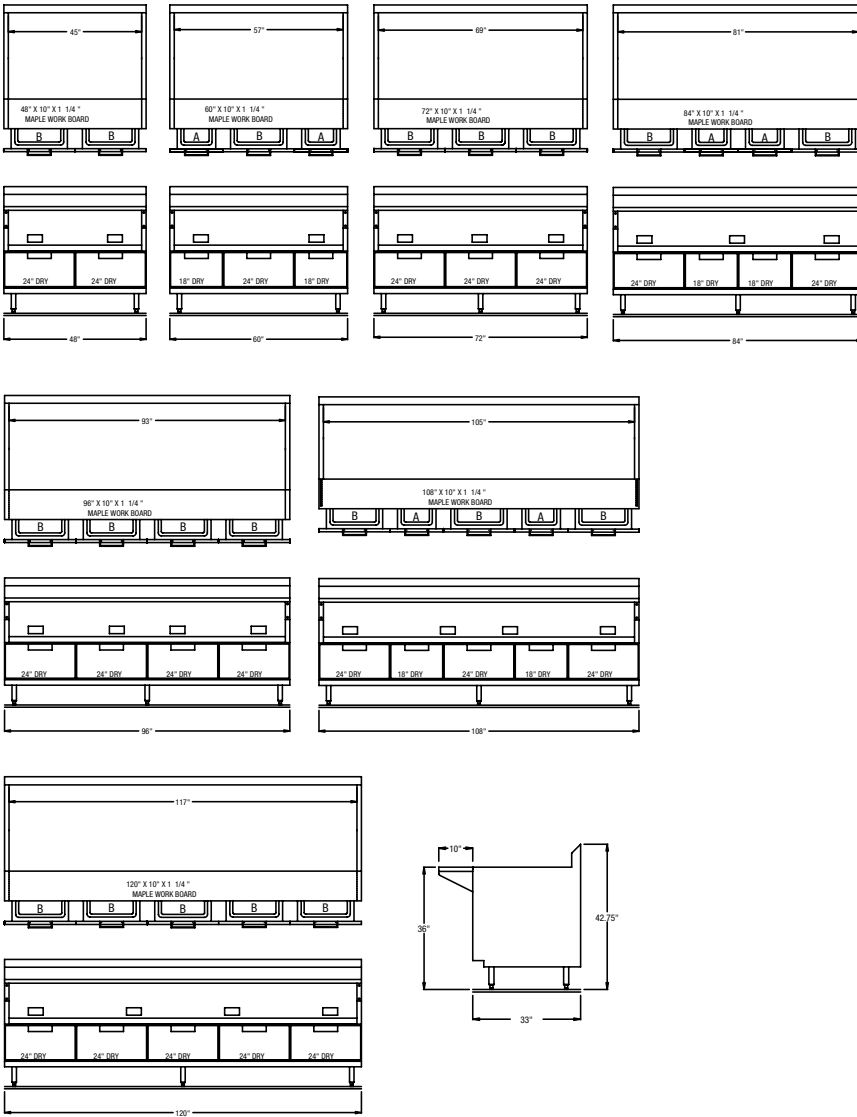

29" Deep							
Length	48"	60"	72"	84"	96"	108"	120"
Height*	36"	36"	36"	36"	36"	36"	36"
Drawers	(2)24"	(2) 18" (2) 24"	(3) 24"	(2) 18" (2) 24"	(4)24"	(2) 18" (3) 24"	(5) 24"
Ship Wt. (lbs)	279	329	377	427	476	526	570
33" Deep							
Length	48"	60"	72"	84"	96"	108"	120"
Model No.	22348	22360	22372	22384	22396	22608	22620
Height*	36"	36"	36"	36"	36"	36"	36"
Drawers	(2)24"	(2) 18" (2) 24"	(3) 24"	(2) 18" (2) 24"	(4)24"	(2) 18" (3) 24"	(5) 24"
Ship Wt. (lbs)	279	329	377	427	476	526	570

- Equipment shelf depth is 25" deep on 29" deep equipment.
- Equipment shelf depth is 29" deep on 33" deep equipment.
- Inside clearance = total unit length less 3"

* All models with adjustable and movable legs for 35 1/2" to 36 3/4" work height.