



STEAMERS

HYPERSTEAM PRESSURELESS CABINET MOUNTED ELECTRIC MODEL HY-6E

Steamer shall be a Groen Model HY-6E stainless steel pressureless steamer with twin atmospheric 9KW electric steam generators, for a total power input of 18KW.

CONSTRUCTION: Steamer cavities and cabinet base shall be all stainless steel construction. Steamer unit back, left side, top and front panels shall be a unitized body, with removable right side panel providing access to internal components. Steamer doors are all stainless steel, with strong continuous hinges and are field-reversible for left or right-swing. Doors shall be insulated and provided with a one-piece, replaceable seal. Easy-open handle and latch shall provide positive lock and seal when door is pushed or slammed shut. Hidden magnetic door switch cuts power to blower and cuts power to generator when the door is opened. Pan support racks shall be polished stainless steel and removable for easy cleaning. Wide drip sink with condensate drain is positioned under cavity doors. 21-5/8" wide cabinet base shall have stainless steel frame with removable front, side and back panels standard. Cabinet base shall be provided with 6" legs with adjustable bullet feet.

FINISH: Cabinet exterior, including door, shall be finished to a #3 uniform finish. Cavity interiors are polished stainless steel. Control panel face plates shall be smudge-resistant polyester film, ensuring maximum ease in cleaning and maintaining an attractive appearance.

UL & CUL LISTING: Steamer shall be UL and Canadian UL-listed.

SANITATION: Unit shall be designed and manufactured to meet NSF requirements and be NSF-listed. Unit shall allow operator to delime steam generator through access port on top, without tools or service call. Push button auto-delime feature is standard.

CONTROLS: Steamer controls shall include an ON-OFF power button; 60-minute electro-mechanical timer, with continuous steam setting; and READY light which indicates when cavity is ready for steaming. Auto-Delime button initiates deliming cycle.

PERFORMANCE FEATURES: Each steamer cavity shall have a powerful side-mounted blower, which increases steam velocity and provides efficient steam distribution throughout cavity and between loaded pans. Steam generators deliver 3KW input per 2-1/2" steam pan. Heat-up time to READY shall be 8-10 minutes, under normal conditions. Cavities are kept warm and ready for instant steam between loads. No cavity warm up required, after READY light comes on. DELIME indicator light warns operator of need to delime generator. Unit will shut off if water level is low. When power switch is turned off, unit automatically blows down the steam generator, to reduce sediment build-up.

ATMOSPHERIC STEAM GENERATOR: Unit shall have twin electric-heated, cabinet-mounted steam generators to provide atmospheric steam to the chambers at a temperature of approximately 212° F. Each steam generator has an electric water sensor. Each 9KW electric heating element is replaceable from the front.

PAN CAPACITY:

Pan Size/Type	Per cavity	Total
12 x 20 x 1"	6	12
12 x 20 x 2-1/2"	3	6
12 x 20 x 4"	2	4

INSTALLATION: Unit requires 208, 240 or 480 Volt, single or three-phase electric service. Unit requires two 3/4" NH cold water supply lines and 1-1/2" O.D. free venting drain. A second cold water connection is also provided for the spray condenser.

WATER QUALITY REQUIREMENTS:

Containment	Water Supply
pH	7 to 9
Total Dissolved Solids (TDS)	30 to 60 ppm
Hardness	less than 60 ppm
Chlorine and Chloramine	less than .1 ppm
Chlorides	less than 30 ppm
Silica	less than 12 ppm
Undissolved Solids	less than 5 microns

CONTINUED ON BACK...

Certifications:

PROJECT NAME:	
LOCATION:	
ITEM NO:	
QTY:	
MODEL NO:	
AIA NO:	
SIS NO:	
CSI SECTION:	11400



OPTIONS/ACCESSORIES:

- Flanged feet kit
- Caster kit
- Single water connection (cold water) adaptor

ADDITIONAL RESOURCES:

[Request A Quote](#)

[Sales Tools](#)

[Find A Rep](#)

HyPerSteam
140796 RevE

08/23

In order to accurately choose the correct water treatment solution, a water quality test has to be performed. If a "Free Start-up" is requested, the ASA will perform a water quality test and Unified Brands (UB) will be able to suggest the best solution for your water quality. If it isn't, your local manufacturing representative can coordinate this for you.

After the "Free Start-up" is performed, UB will add an additional 1-year parts and labor warranty. If UB suggests a water treatment system, the system is purchased from UB, installed and maintained, water related service issues will be covered for the duration of the warranty period.

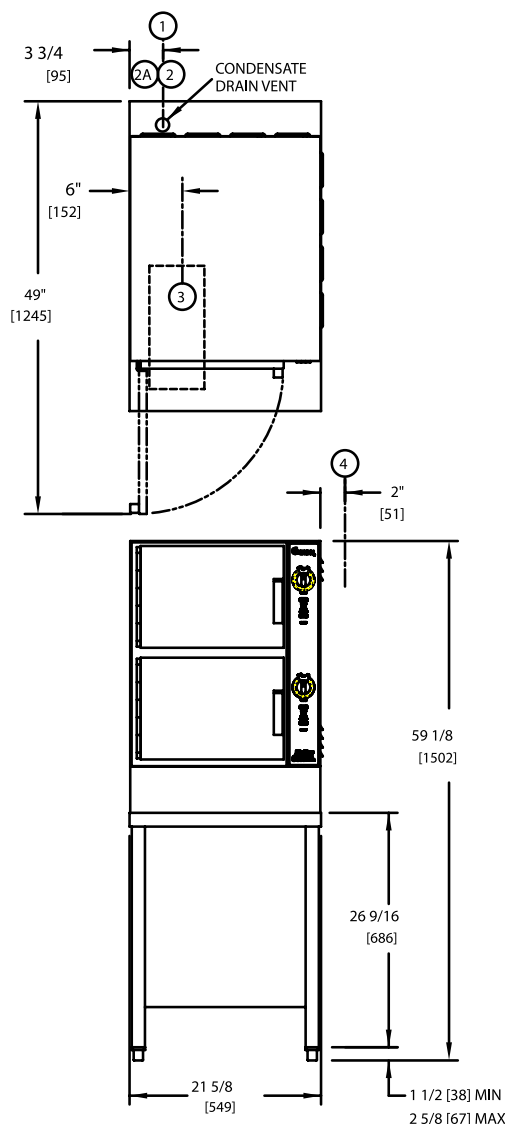

DIMENSIONS IN BRACKETS [] ARE MM

VOLTAGE	PHASE	AMPS	MAX. KW
208	1	87	18
	3	53	18
240	1	75	18
	3	46	18
480	---	---	---
	3	23	18

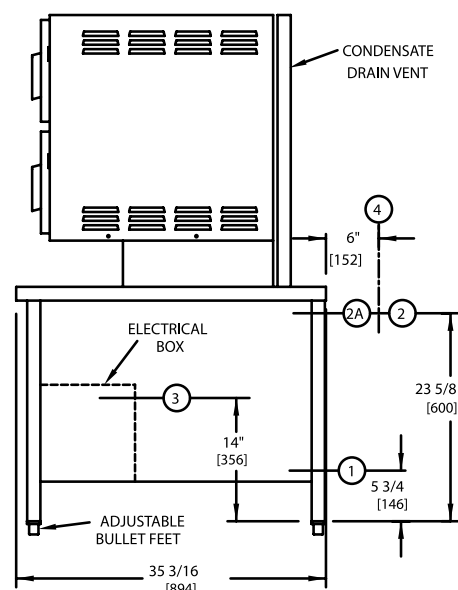

SERVICE CONNECTIONS AND NOTES:

1. DRAIN CONNECTION 1 1/2" [38] TUBE (DRAIN FREE VENTING)
2. TREATED WATER SUPPLY AT 30 TO 60 PSIG WITH A FLOW RATE OF 1.50-3.00 GPM AND WITH A 3/4" NH CONNECTION.
- 2A. UNTREATED WATER SUPPLY AT 30 TO 60 PSIG WITH A FLOW RATE OF 1.50-3.00 GPM AND WITH A 3/4" NH CONNECTION.
3. ELECTRICAL CONNECTION 1" CONDUIT. SEE TABLE FOR REQUIREMENTS.
4. MINIMUM CLEARANCE REQUIRED: REAR = 6" [152], LEFT SIDE = 0" [0], RIGHT SIDE 2" [51]

