



# SERVING STATIONS

## DROP-IN HOT WELL MODELS 9560

Electric operated, stainless steel drop-in hot food well unit w/ individual die-stamped 12" x 20" top openings, individual thermostatically controlled sealed food wells designed for wet operation. Controls mounted on separate pre-wired s/s control panel. Unit is totally pre-wired to junction box for single-point field connection.

**SHORT FORM SPEC:** Drop-in hot food well unit with individual die-stamped 12" x 20" top openings, electrically heated sealed food wells with or without drain(s). Separate pre-wired s/s control panel houses individual thermostatic controls. Unit is totally pre-wired to junction box for single-point field connection. UL Listed, NSF.

### AVAILABLE MODELS:

Note: xxx represents voltage; 120, 208, 240

#### WITH DRAINS & MANIFOLD:

9560-1-xxxDM  
9560-2-xxxDM  
9560-3-xxxDM  
9560-4-xxxDM  
9560-5-xxxDM  
9560-6-xxxDM  
9560-2N-xxxDM (Slim)  
9560-3N-xxxDM (Slim)

#### WITH NO DRAINS:

9560-1xxx  
9560-2xxx  
9560-3xxx  
9560-4xxx  
9560-5xxx  
9560-6xxx

### STANDARD FEATURES:

- Designed for wet operation
- Individually controlled wells for maximum operator control
- True thermostatic control for precise food temperatures
- Die stamped, raised sanitary rim pan openings in stainless steel top
- Available for 120V, 208V, or 240 volt operation
- Available with or without drains

**UNIT TOP:** Top to be one piece 18 gauge stainless steel. Top openings to be die-stamped with raised perimeter rims.

**FOOD WELLS:** Units fitted with compliment of 12" x 20" x 6 1/2" deep, electrically heated, sealed food wells, designed for wet operation, and are individually and thermostatically controlled. Unit prewired to controls, mounted on separate stainless steel panel. Note: If optional drains & manifold are ordered, common gate is provided installed.

**UNIT BODY:** Fully insulated exterior body of corrosion resistant steel.

**CONTROLS:** Thermostatic controls (prewired to junction box) mounted on separate stainless steel panel for field installation in counter front. Each control has a lighted on/off power indicator. Connections to heating elements to be located outside of heated zone to avoid wiring deterioration.

Certifications:  

PROJECT NAME:	
LOCATION:	
ITEM NO:	
QTY:	
MODEL NO:	
AIA NO:	
SIS NO:	
CSI SECTION:	11400



9560-4 Shown

### OPTIONS/ACCESSORIES:

Adaptor Bars  
Extended Thermostatic Lead  
500 Watt Low Wattage Elements  
Auto Water Fill (see 9560AWF spec sheet)

### ADDITIONAL RESOURCES:

[Request A Quote](#)

[Sales Tools](#)

[Find A Rep](#)

[KCL AutoCAD/Revit](#)

**Serving Stations**  
**SP SHT1917 RevC**  
02/25

9560-1

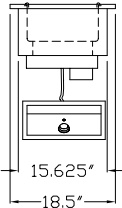
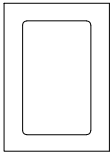

9560-2

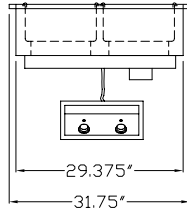
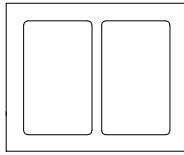

9560-3

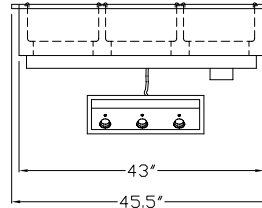
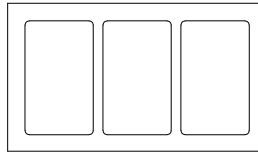

9560-4

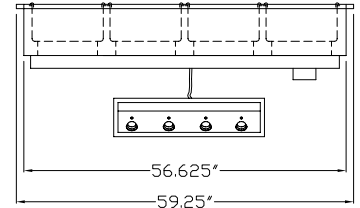
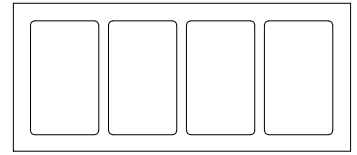

9560-5

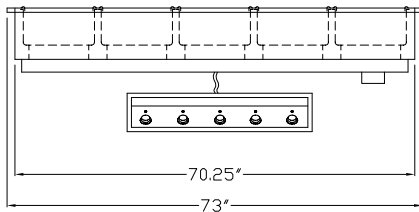
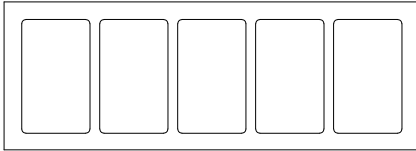

9560-6

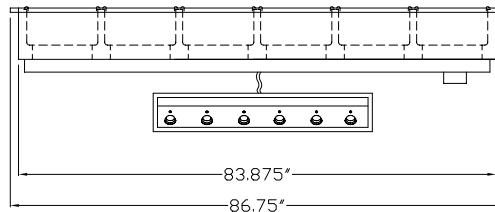
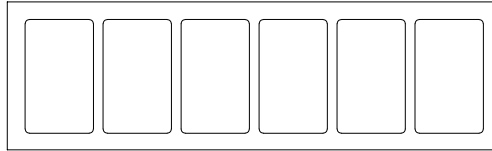

9560 END VIEW

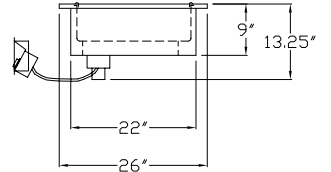

9560-2N

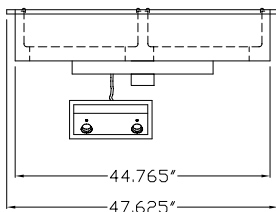
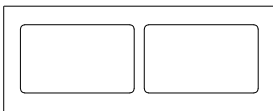

9560-3N

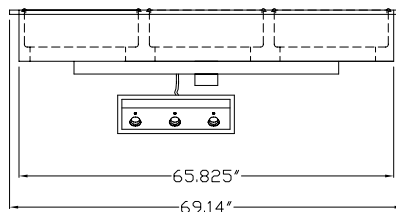
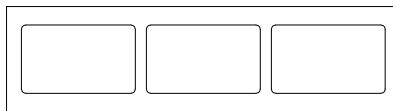

9560-N END VIEW

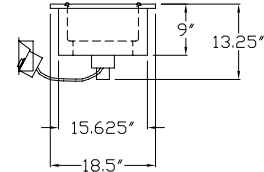

#### DM MODEL DRAIN VALVE LOCATION:

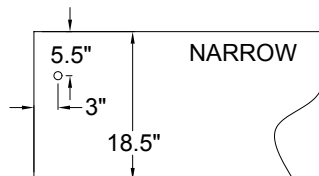
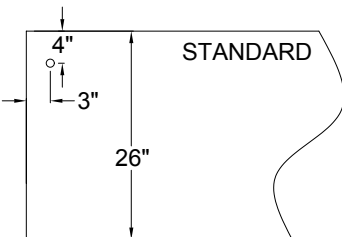

Model*	Length	Width	Pan Capacity 12" x 20"	Body Size	Control Panel Size	Amps 120V	Amps 208V	Amps 240V	Approx. Weight
WITH DRAINS & MANIFOLD									
95601-xxxD	18.5"	26"	1	16.125" x 22.5"	14.25" x 5.75" x 6"	9.2	5.3	4.6	60
95602-xxxD	31.75"	26"	2	29.875" x 22.5"	14.25" x 5.75" x 6"	18.4	10.6	9.2	100
95603-xxxD	45.5"	26"	3	43.5" x 22.5"	20" x 5.75" x 6"	27.6	15.9	13.8	140
95604-xxxD	59.25"	26"	4	57.125" x 22.5"	26" x 5.75" x 6"	36.8	21.2	18.4	180
95605-xxxD	73"	26"	5	70.75" x 22.5"	32" x 5.75" x 6"	46	27.5	23	220
95606-xxxD	86.75"	26"	6	84.375" x 22.5"	38" x 5.75" x 6"	55.2	31.7	27.6	260
95602N-xxxD	47.6"	18.5"	2	45.264" x 16.125"	14.25" x 5.75" x 6"	18.4	10.6	9.2	100
95603N-xxxD	69.2"	18.5"	3	66.327" x 16.125"	20" x 5.75" x 6"	27.6	15.9	13.8	140
WITH NO DRAINS									
95601-xxx	18.5"	26"	1	16.125" x 22.5"	14.25" x 5.75" x 6"	9.2	5.3	4.6	60
95602-xxx	31.75"	26"	2	29.875" x 22.5"	14.25" x 5.75" x 6"	18.4	10.6	9.2	100
95603-xxx	45.5"	26"	3	43.5" x 22.5"	20" x 5.75" x 6"	27.6	15.9	13.8	140
95604-xxx	59.25"	26"	4	57.125" x 22.5"	26" x 5.75" x 6"	36.8	21.2	18.4	180
95605-xxx	73"	26"	5	70.75" x 22.5"	32" x 5.75" x 6"	46	27.5	23	220
95606-xxx	86.75"	26"	6	84.375" x 22.5"	38" x 5.75" x 6"	55.2	31.7	27.6	260
95602N-xxx	47.6"	18.5"	2	45.264" x 16.125"	14.25" x 5.75" x 6"	18.4	10.6	9.2	100
95603N-xxx	69.2"	18.5"	3	66.327" x 16.125"	20" x 5.75" x 6"	27.6	15.9	13.8	140

Power supply requires hard wiring to "J" box. \*Note: xxx represents voltage; 120, 208, 240