



PREP STATIONS

SPECIALTY CUSTOM FLAT CONDIMENT NARROW OPENING MODELS 53000LPP0

Remote "low profile" drawer base refrigerator storage unit with plate shelf above the drawers and a mechanically cooled pan opening. Cold-wall conductive cooled pan opening with recessed pan ledge provides easy reach and cold above pans for optimal temperatures. Separate base and pan opening controllers give the operator precise control of the temperature in each zone and the ability to shut the pan opening off at night. Standard clean-out port allows pan opening to be easily cleaned and sanitized.

SHORT FORM SPEC: Randell 53000LPP0 series preparation table with remote refrigeration system. Includes independently controlled mechanically cooled pan opening and refrigerated base, each controlled by their own mechanical control. Single pan opening to come standard with recessed pan ledge, adapter bars and oversized clean-out port for ease of cleanability. Base interior ends and drawer openings shall be high impact ABS plastic with coved corner stainless steel interior to form bottom, back and top of cabinet and be cooled with a blower coil located behind the mullion. Base cabinet standard with plate shelf and heavy-duty cartridge style drawers with press-fit magnetic gaskets. Unit to be shipped standard on adjustable legs mounted to full length leg rails. cUL, UL, NSF.

AVAILABLE MODELS:

1 Section:

53330LPP0
53338LPP0
53343LPP0

2 Sections:

53355LPP0
53360LPP0
53363LPP0
53368LPP0
53373LPP0

3 Sections:

53385LPP0

STANDARD FEATURES:

- Low profile refrigerated cabinet with plate storage shelf
- Cold-wall conductive cooled pan opening with recessed pan ledge for easy reach and cold above pans
- Base cooled by high capacity mullion coil refrigeration system with automatic defrost
- Filter dryer installed on each liquid line
- Independent temp control for pan opening and base allows precise temperature maintenance in each zone
- Drawer cartridge system with easy maintenance press-fit gaskets (removable without tools)
- Exclusive completely sealed pan opening interior with clean-out port allows pan opening to be easily cleaned and sanitized
- Hinged mechanical compartment panel for access to clean-out port
- 6" high legs, adjustable and movable along full length leg rail
- Available up to 16' under one common assembly
- Adapter bars to accommodate a compliment of 1/6 size pans

REFRIGERATION SYSTEM: Refrigerant to be specified by customer (Specification based on R-448a refrigerant). The base and pan opening are thermostatically controlled operating on independent solenoid and expansion valves. (located in the mechanical housing at the rear of the unit) The pan opening is conductively cooled by coldwall wrapped tank utilizing Randell's exclusive aluminum cold transfer plates to maximum heat removal capacity. An on/off switch for the pan opening is provided. Interior fitted with Randell evaporator blower coil for cooling base. Condensing unit not provided. Unit prewired to junction box for 115V operation. Electric condensate evaporator is optional.

CABINET EXTERIOR: Top to be one piece of die-formed 16 gauge stainless steel with 2 1/2" nosing with full length plate shelf below. Ends at top fitted with recessed heavy duty steel bars for field bolting units together, producing a hairline seam. Hinged panel to be stainless steel. Exterior body to be corrosion resistant steel. Drawer opening frames are ABS and contain magnetic strip for positive seal of drawer gaskets. Work surface to be at 36" work height. Legs to be 6" high stainless steel with adjustable bullet foot. Legs mounted to full length channel frame assembly which is integrally welded to bottom of body assembly. Legs can be moved left to right to avoid floor obstacles during installation.

CABINET INTERIOR: Base interior to be ABS thermoplastic at ends only. Stainless steel interior liner to be coved cornered to form bottom, back and top. Unit insulation to be CFC free foamed in place urethane.

REFRIGERATED DRAWERS: Fully welded, unitized drawer cartridge assembly - patented. Heavy duty full extension 14 gauge drawer tracks on 1-5/8" heavy duty stainless steel bearings. Pans not included. Quick release allows drawers to be easily removed for cleaning. Stainless fronts, mounted to drawer cartridge assembly with easy to grasp drawer handles. Drawers with press fit magnetic gaskets - (designed for installation and removal without tools).



PROJECT NAME:	
LOCATION:	
ITEM NO:	
QTY:	
MODEL NO:	
AIA NO:	
SIS NO:	
CSI SECTION:	11400



53360LPP0 shown

OPTIONS/ACCESSORIES:

Cabinet:

Remove backsplash
Replace drawer set with door (19" & 27" only)
Intermediate shelves
Adjustable shelves
Stainless steel finished back
Stainless steel finished ends
Laminate fronts, ends and back
Electric condensate evaporator
Drawer lock(s)

Pan Opening Covers:

Hood cover with slide-back front
Lift-off (removable)
See-through hinged cover
Hinged slide-back cover

Work-Surface:

White poly cutting board, 1/2" or 3/4"
Richlite cutting board, 1/2" or 3/4"
Wire prep racks (for placement on stainless steel surface)

Additional Storage:

Partial length pan opening
Overshelfing storage options

ADDITIONAL RESOURCES:

[Request A Quote](#)

[Sales Tools](#)

[Find A Rep](#)

[KCL AutoCAD/Revit](#)

53330LPP0

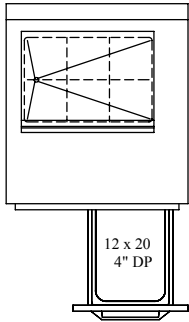

53338LPP0

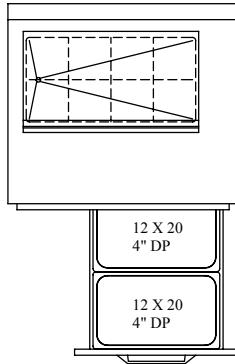

53343LPP0

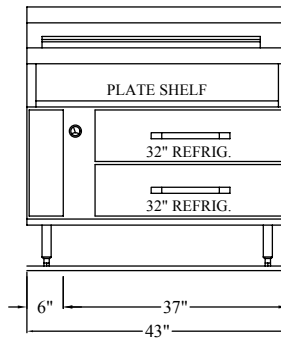
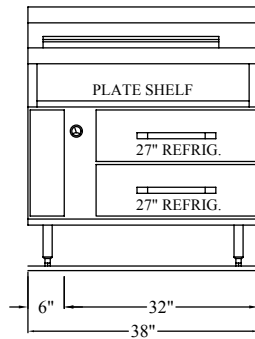
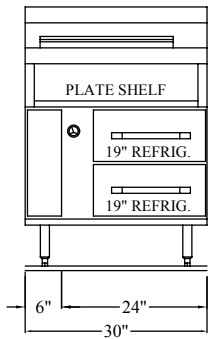
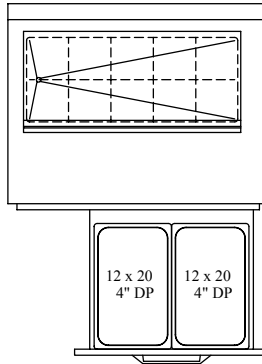

MODEL	LENGTH (IN)	DEPTH (IN)	HEIGHT (IN)	TOP-PAN OPENING CAPACITY 1/6 SIZE PAN	BASE-DRAWER SET CONFIGURATION	TOTAL DRAWER PAN CAPACITY	VOLT/ CYCLE/ PHASE	AMPS	BTU LOAD (-10) PAN OPENING, (+20F)BASE	EVAP. BTU/TD** OPENING/ BASE	SHIP WT.
1 SECTION BASE STORAGE-REMOTE REFRIGERATORS WITH NARROW DEPTH PAN OPENING											
53330LPP0	30	34	42.75	6	(1) SET 19"	(2) 12x20x4"	115/60/1	5	227/446	13/120	391
53338LPP0	38	34	42.75	8	(1) SET 27"	(4) 12x20x4"	115/60/1	5	302/563	16/120	422
53343LPP0	43	34	42.75	10	(1) SET 32"	(4) 12x20x4"	115/60/1	5	378/636	19/120	463

NOTES: *BTU loads shown are based on 100° ambient plus 30% for usage and product loading in base. Final system selection should consider usage requirements and combined loads. **Evaporator BTU/*TD reflects NSF refrigerated base requirements when base is provided with +20° F system separate from -10°F pan opening system. ***Additional length added to mechanical housing

53355LPP0

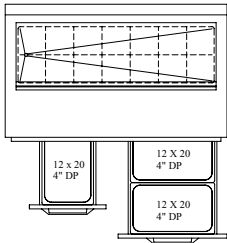

53360LPP0

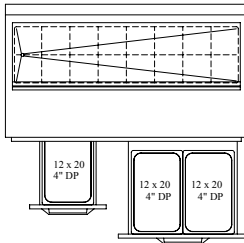

53363LPP0

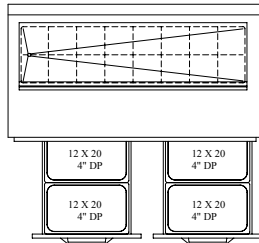

53368LPP0

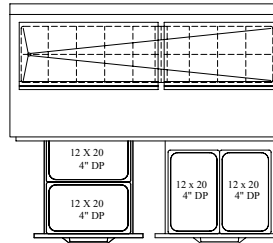

53373LPP0

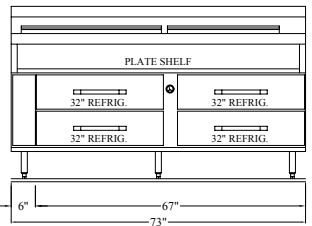
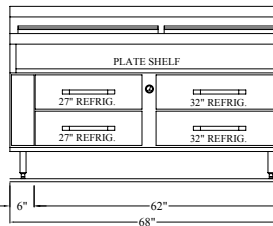
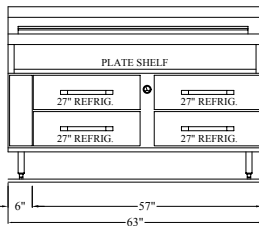
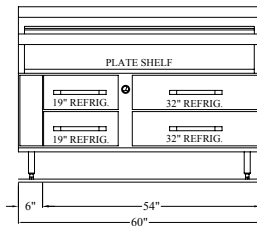
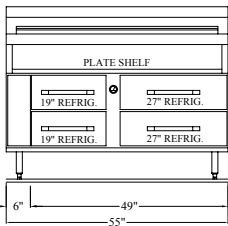
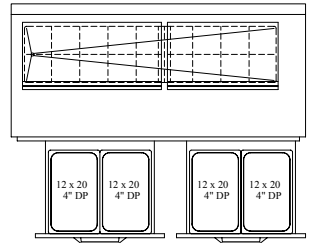

53385LPP0

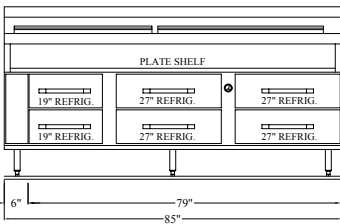
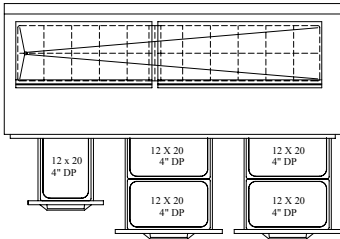

MODEL	LENGTH (IN)	DEPTH (IN)	HEIGHT (IN)	TOP-PAN OPENING CAPACITY 1/6 SIZE PAN	BASE-DRAWER SET CONFIGURATION	TOTAL DRAWER PAN CAPACITY	VOLT/ CYCLE/ PHASE	AMPS	BTU LOAD (-10) PAN OPENING, (+20F)BASE	EVAP. BTU/TD** OPENING/ BASE	SHIP WT.
2 SECTION BASE STORAGE-REMOTE REFRIGERATORS WITH NARROW DEPTH PAN OPENING											
53355LPP0	55	34	42.75	14	(1) SET 19", (1) SET 27"	(6) 12x20x4"	115/60/1	5	454/791	22/120	524
53360LPP0	60	34	42.75	16	(1) SET 19", (1) SET 32"	(6) 12x20x4"	115/60/1	5	605/996	27/120	571
53363LPP0	63	34	42.75	16	(2) SETS 27"	(8) 12x20x4"	115/60/1	5	605/1040	27/120	587
53368LPP0	68	34	42.75	18	(1) SET 27", (1) SET 32"	(8) 12x20x4"	115/60/1	5	680/1113	30/120	602
53373LPP0	73	34	42.75	18	(2) SETS 32"	(8) 12x20x4"	115/60/1	5	680/1186	30/120	617
3 SECTION BASE STORAGE-REMOTE REFRIGERATORS WITH NARROW DEPTH PAN OPENING											
53385LPP0	85	34	42.75	22	(1) SET 19", (2) SETS 27"	(10) 12x20x4"	115/60/1	5	832/1472	36/120	717

NOTES: *BTU loads shown are based on 100° ambient plus 30% for usage and product loading in base. Final system selection should consider usage requirements and combined loads. **Evaporator BTU/TD reflects NSF refrigerated base requirements when base is provided with +20° F system separate from -10°F pan opening system. ***Additional length added to mechanical housing

DIMENSIONAL DETAIL:

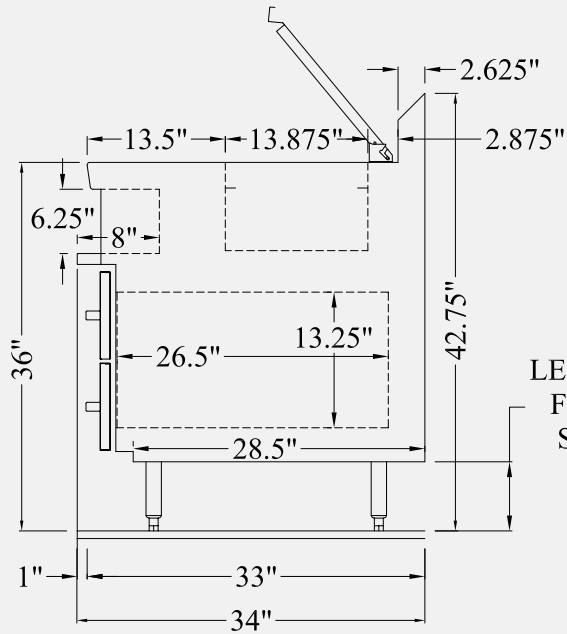

LEGS ADJUSTABLE
 FROM: 6" - 7.125"
 SHOWN @ 6.75"

Stainless Steel Finished End:

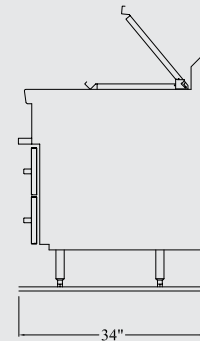

Unfinished End:

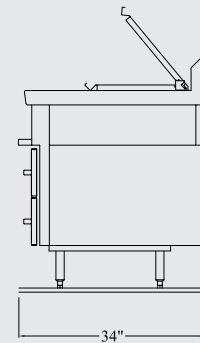

OPTIONAL COVERS:

Hinged Cover (standard):

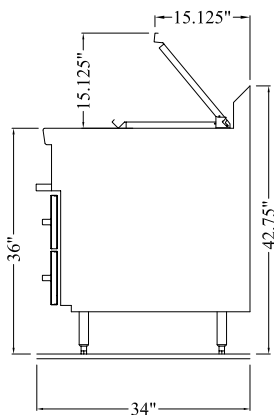

Hinged Slide-Back Cover:

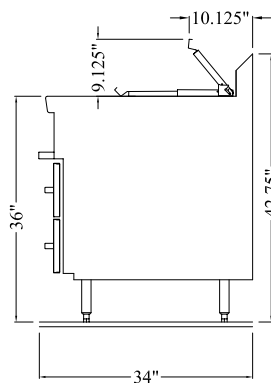

Lift-Off Cover:

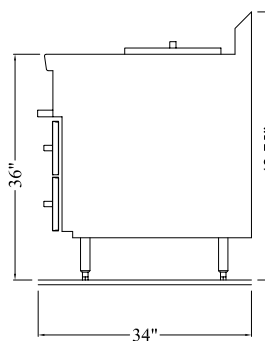

Hood Cover:

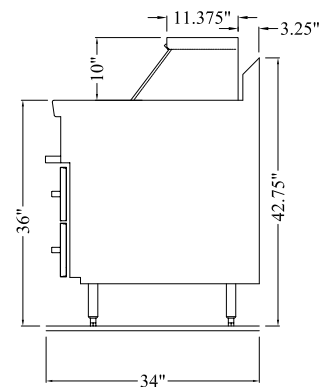

*Units shown with optional stainless steel end panels.