



# PREP STATIONS

## SPECIALTY CUSTOM SELF-CONTAINED RAISED COLDWALL REFRIGERATOR MODELS NPR

Self-contained refrigerator storage unit with mechanically cooled raised rail. Cold-wall conductive cooled low profile raised rail w/ recessed pan ledge provides easy reach and cold above pans for optimal temperatures. Separate base and rail controllers give the operator precise control of the rail temperature and the ability to shut the rail off at night-conserves up to 60% of the daytime energy usage. Raised rail is standard with clean-out port valve allowing pan opening to be easily cleaned and sanitized.

**SHORT FORM SPEC:** Randell NPR series preparation table with natural R290 refrigeration system. Includes independently controlled mechanically cooled rail and refrigerated base, each controlled by their own electronic control. Single opening, raised rail to come standard with recessed pan ledge, adapter bars and oversized clean-out port for ease of cleanability. Base interior ends and door openings shall be high impact ABS plastic with coved corner stainless steel interior to form bottom, back and top of cabinet and be cooled with a blower coil located behind the mullion. Base cabinet doors to have heavy duty 16 ga. top mounted handles and include press-fit magnetic gaskets. Unit to be shipped standard on adjustable legs mounted to full length leg rails. cUL, UL, NSF.

### AVAILABLE MODELS:

<b>1 Section:</b>	<b>3 Sections:</b>	<b>4 Sections:</b>
NPR1x130	NPR2x357	NPR2x484
NPR1x133	NPR2x360	NPR2x487
<b>2 Sections:</b>	NPR2x363	NPR2x490
NPR1x236	NPR2x366	NPR2x493
NPR1x239	NPR2x369	NPR2x496
NPR1x242	NPR2x372	NPR2x499
NPR1x245	NPR2x375	NPR2x4102
NPR1x248	NPR2x378	NPR2x4105
NPR1x251	NPR2x381	NPR2x4108
NPR1x254		

### STANDARD FEATURES:

- Cold-wall conductive cooled low profile raised rail with recessed pan ledge for easy reach and cold above pans
- Base cooled by high capacity mullion coil refrigeration system with adaptive defrost
- Independent temp control for rail and base allows precise temperature maintenance in each zone
- 100% front breathing compressor housing allows sealing to wall and curb mounting without special requirements
- Easy maintenance press-fit gaskets (removable without tools)
- Exclusive completely sealed pan rail interior with clean-out port allows pan opening to be easily cleaned and sanitized
- Hinged compressor compartment panel for access to clean-out port and condenser coil cleaning
- 6" high legs, adjustable and movable along full length leg rail
- Available up to 16' under one common assembly
- Adapter bars to accommodate a compliment of 1/6 size pans
- Interior lighting inside the base cabinet

**REFRIGERATION SYSTEM:** All models will utilize state of the art, energy efficient R290 compressor systems with (0) ozone depletion (ODP) and (3) global warming potential (GWP). The pan rail is conductively cooled by coldwall wrapped tank utilizing Randell's exclusive aluminum cold transfer plates to maximum heat removal capacity. Independently controlled rail and base temperatures are managed by electronic controllers metered using capillary tube systems. Independent rail control (separate from the base cabinet temperature control) allows the operator precise control of the rail and the ability to shut the rail off at night for

energy savings up to 60% of the daytime usage. Independent base control featuring adaptive defrost allows precise control of the base cabinet.

**CABINET EXTERIOR:** Top to be one piece of die-formed 16 gauge stainless steel with 2 1/2" nosing. Ends at top fitted with recessed heavy duty steel bars for field bolting units together, producing a hairline seam. Hinged louver panel to be stainless steel. Exterior body to be corrosion resistant steel. Door opening frames are ABS and contain magnetic strip for positive seal of door gaskets. Work surface to be at 36" work height. Legs to be 6" high stainless steel with adjustable bullet foot. Legs mounted to full length channel frame assembly which is integrally welded to bottom of body assembly. Legs can be moved left to right to avoid floor obstacles during installation.

**CABINET INTERIOR:** Base interior to be ABS thermoplastic at ends only. Stainless steel interior liner to be coved cornered to form bottom, back and top. One baked enamel finished shelf provided behind each door. Unit insulation to be CFC free foamed in place urethane.

**DOORS:** Door fronts to be 22-gauge stainless steel exterior front with 16 gauge stainless steel door pulls/handles. The interior liner is vacuum formed ABS with integral gasket retainer for easy cleaning and accepts Randell's Exclusive Press Fit Gasket system. Doors are mounted on concealed hinges. One removable wire shelf is supplied behind each door.



PROJECT NAME:	
LOCATION:	
ITEM NO:	
QTY:	
MODEL NO:	
AIA NO:	
SIS NO:	
CSI SECTION:	11400



NPR1L254-shown with stainless steel finished end and double drawers in section 1

### OPTIONS/ACCESSORIES:

- Cabinet:**
- Extra shelves
  - Adjustable shelves
  - Pull-out shelves (24" & 27" doors only)
  - Two-tier drawers (6" deep pans)
  - Triple-tier drawers (4" deep pans) (27" & 32" only)
  - Tray racks for 18"x26" sheet pans (24" & 27" doors only)
  - Stainless steel finished back
  - Stainless steel finished ends
  - Laminate fronts, ends and back
  - Casters in lieu of legs
  - Door/Drawer lock(s)
- Pan Rail Covers:**
- Hood cover with slide-back front
  - Lift-off (removable)
  - See-through hinged cover
  - Hinged slide-back cover
- Work-Surface:**
- White poly cutting board, 1/2" or 3/4"
  - Richlite cutting board, 1/2" or 3/4"
  - Wire prep racks (for placement on stainless steel surface)
  - Built-in prep racks with catch pans
- Additional Storage:**
- Partial length pan rail
  - Flat-top rail (non angled)
  - Overshelfing storage options
- Voltage:**
- 220-230V/50-60Hz supplied with cord (plug provided in field by others)

### ADDITIONAL RESOURCES:

- [Request A Quote](#)
- [Sales Tools](#)
- [Find A Rep](#)
- [KCL AutoCAD/Revit](#)

NPR1L130

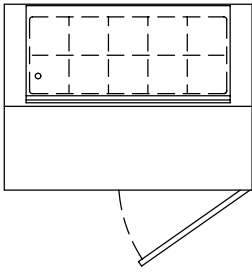

NPR1L133

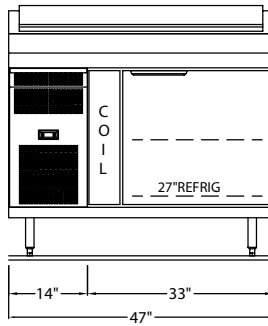
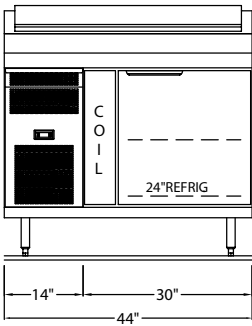
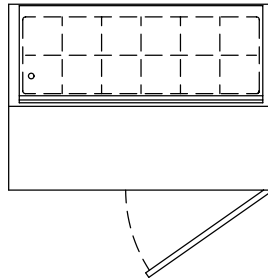

MODEL	COMPRESSOR		BASE SECTION(S)	STANDARD REF. BASE CONFIGURATION	MIN. UNIT LENGTH*	PAN RAIL CAPACITY 1/6 SIZE PAN	BASE STORAGE CUBIC FT/ DRAWER CAPACITY	H.P./ REFRIGERANT	VOLT/ CYCLE/ PHASE	AMPS	NEMA PLUG	SHIP WT.
	QTY/COMP. HSG SIZE	LOCATION "x"										
<b>1 SECTION BASE STORAGE-SELF CONTAINED REFRIGERATORS WITH NARROW DEPTH RAISED RAIL</b>												
<b>NPR1x130</b>	(1)-14" MINIMUM	R= RIGHT, L=LEFT	1	(1) 24" DOOR, 6" COIL	44	10	5.98	1/3-R290	115/60/1	6	5-15P	489
<b>NPR1x133</b>	(1)-14" MINIMUM	R= RIGHT, L=LEFT	1	(1) 27" DOOR, 6" COIL	47	12	6.91	1/3-R290	115/60/1	6	5-15P	510

\*Additional length added to compressor housing.

All drawings shown with compressor left (NPRxL) version of unit; compressor right model (NPRxR) is mirrored. Section sizes and locations may be adjusted within the footprint of the model.

NPR1L236

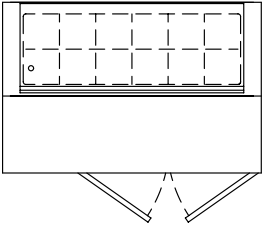

NPR1L239

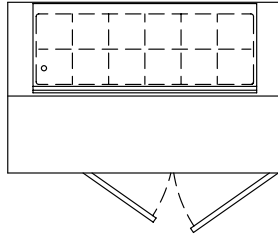

NPR1L242

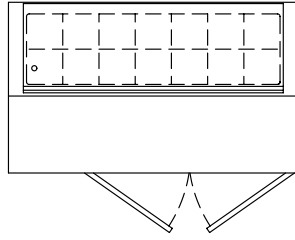

NPR1L245

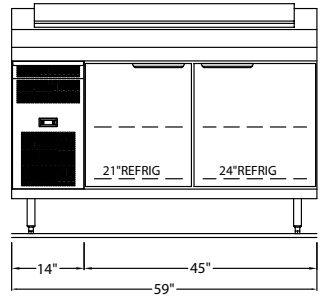
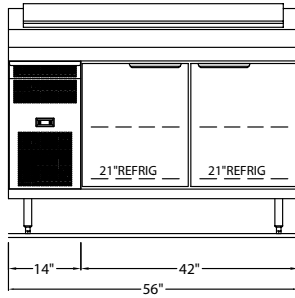
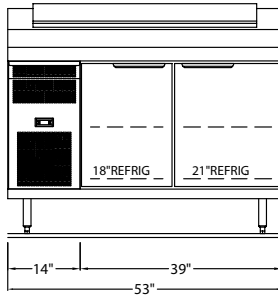
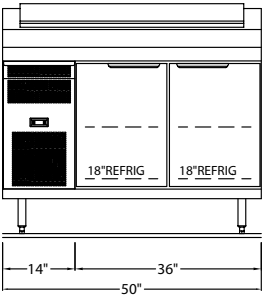
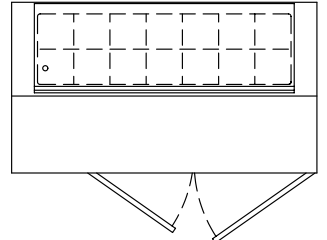

NPR1L248

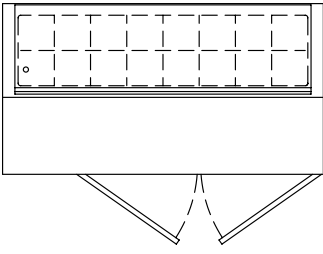

NPR1L251

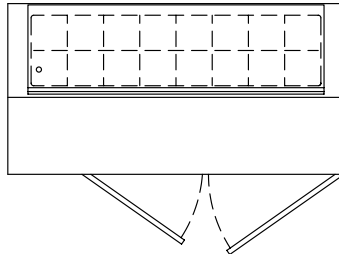

NPR1L254

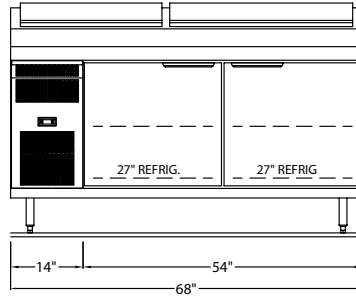
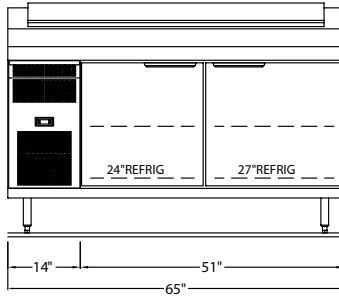
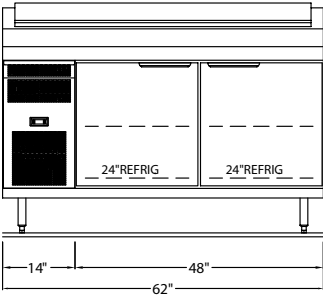
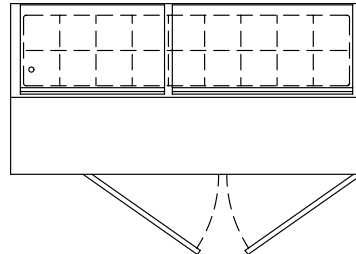

All drawings shown with compressor left (NPRxL) version of unit; compressor right model (NPRxR) is mirrored. Section sizes and locations may be adjusted within the footprint of the model.

MODEL	COMPRESSOR		BASE SECTION(S)	STANDARD REF. BASE CONFIGURATION	MIN. UNIT LENGTH*	PAN RAIL CAPACITY 1/6 SIZE PAN	BASE STORAGE CUBIC FT/ DRAWER CAPACITY	H.P./ REFRIGERANT	VOLT/ CYCLE/ PHASE	AMPS	NEMA PLUG	SHIP WT.
	QTY/COMP. HSG SIZE	LOCATION "x"										
<b>2 SECTION BASE STORAGE-SELF CONTAINED REFRIGERATORS WITH NARROW DEPTH RAISED RAIL</b>												
<b>NPR1x236</b>	(1)-14" MINIMUM	R= RIGHT, L=LEFT	2	(2) 18" DOORS	50	12	8.23	1/3-R290	115/60/1	6	5-15P	542
<b>NPR1x239</b>	(1)-14" MINIMUM	R= RIGHT, L=LEFT	2	(1) 21" DOOR, (1) 18" DOOR	53	12	9.16	1/3-R290	115/60/1	6	5-15P	563
<b>NPR1x242</b>	(1)-14" MINIMUM	R= RIGHT, L=LEFT	2	(2) 21" DOORS	56	14	10.09	1/3-R290	115/60/1	6	5-15P	584
<b>NPR1x245</b>	(1)-14" MINIMUM	R= RIGHT, L=LEFT	2	(1) 21" DOOR, (1) 24" DOOR	59	14	11.02	1/3-R290	115/60/1	6	5-15P	605
<b>NPR1x248</b>	(1)-14" MINIMUM	R= RIGHT, L=LEFT	2	(2) 24" DOORS	62	16	11.96	1/3-R290	115/60/1	6	5-15P	626
<b>NPR1x251</b>	(1)-14" MINIMUM	R= RIGHT, L=LEFT	2	(1) 24" DOOR, (1) 27" DOOR	65	16	12.89	1/3-R290	115/60/1	6	5-15P	647
<b>NPR1x254</b>	(1)-14" MINIMUM	R= RIGHT, L=LEFT	2	(2) 27" DOORS	68	18	13.82	1/3-R290	115/60/1	6	5-15P	668

\*Additional length added to compressor housing.

NPR2L357

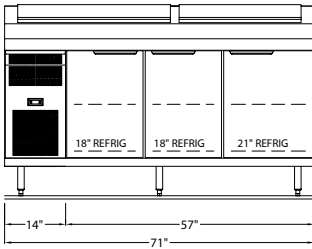
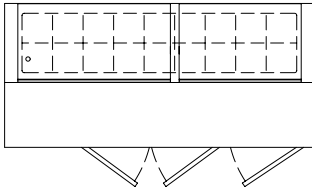

NPR2L360

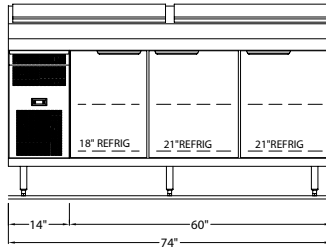
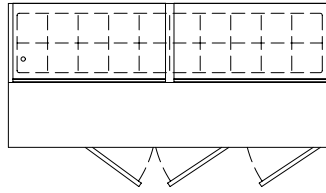

NPR2L363

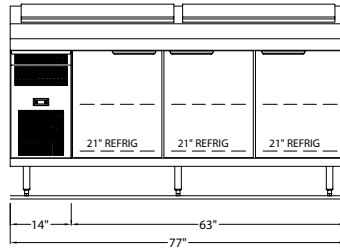
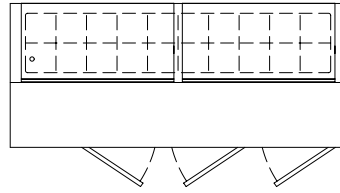

NPR2L366

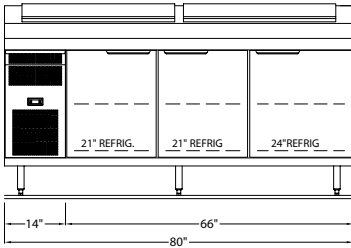
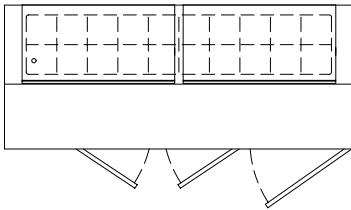

NPR2L369

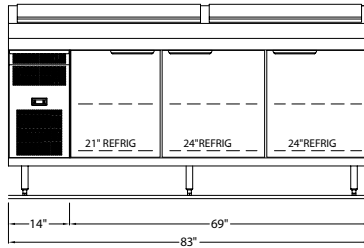
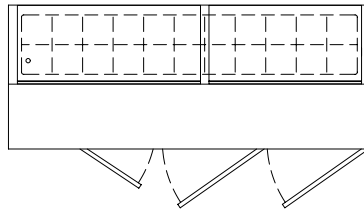

NPR2L372

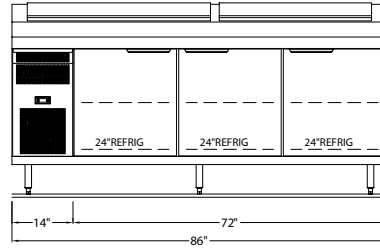
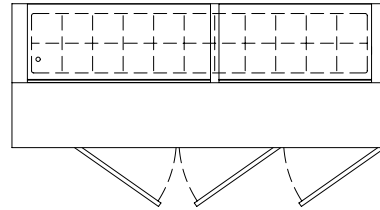

NPR2L375

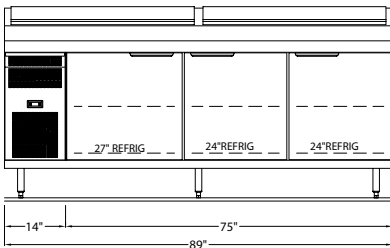
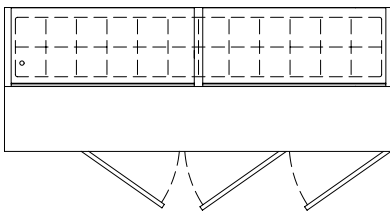

NPR2L378

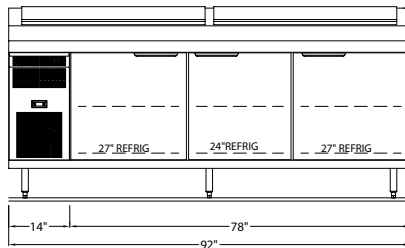
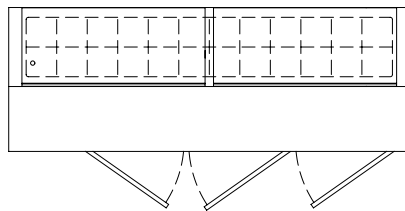

NPR2L381

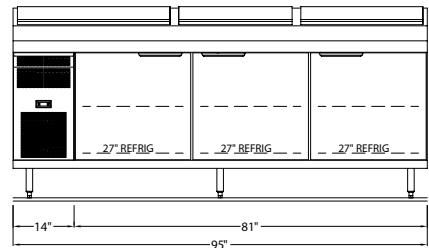
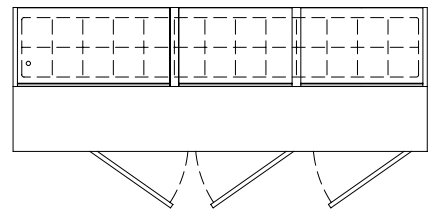

All drawings shown with compressor left (NPRxL) version of unit; compressor right model (NPRxR) is mirrored. Section sizes and locations may be adjusted within the footprint of the model.

MODEL	COMPRESSOR		BASE SECTION(S)	STANDARD REF. BASE CONFIGURATION	MIN. UNIT LENGTH*	PAN RAIL CAPACITY 1/6 SIZE PAN	BASE STORAGE CUBIC FT/ DRAWER CAPACITY	H.P./ REFRIGERANT	VOLT/ CYCLE/ PHASE	AMPS	NEMA PLUG	SHIP WT.
	QTY/COMP. HSG SIZE	LOCATION "x"										
<b>3 SECTION BASE STORAGE-SELF CONTAINED REFRIGERATORS WITH NARROW DEPTH RAISED RAIL</b>												
<b>NPR2x357</b>	(2)-14" MINIMUM	R= RIGHT, L=LEFT	3	(2) 18" DOORS, (1) 21" DOOR	71	18	13.28	(2)1/4-R290	115/60/1	5.8	5-15P	715
<b>NPR2x360</b>	(2)-14" MINIMUM	R= RIGHT, L=LEFT	3	(1) 18" DOOR, (2) 21" DOORS	74	20	14.21	(2)1/4-R290	115/60/1	5.8	5-15P	736
<b>NPR2x363</b>	(2)-14" MINIMUM	R= RIGHT, L=LEFT	3	(3) 21" DOORS	77	20	15.14	(2)1/4-R290	115/60/1	5.8	5-15P	757
<b>NPR2x366</b>	(2)-14" MINIMUM	R= RIGHT, L=LEFT	3	(2) 21" DOORS, (1) 24" DOOR	80	20	16.07	(2)1/4-R290	115/60/1	5.8	5-15P	778
<b>NPR2x369</b>	(2)-14" MINIMUM	R= RIGHT, L=LEFT	3	(1) 21" DOOR, (2) 24" DOORS	83	22	17.00	(2)1/4-R290	115/60/1	5.8	5-15P	799
<b>NPR2x372</b>	(2)-14" MINIMUM	R= RIGHT, L=LEFT	3	(3) 24" DOORS	86	22	17.93	(2)1/4-R290	115/60/1	5.8	5-15P	820
<b>NPR2x375</b>	(2)-14" MINIMUM	R= RIGHT, L=LEFT	3	(1) 27" DOOR, (2) 24" DOORS	89	24	18.87	(2)1/4-R290	115/60/1	5.8	5-15P	841
<b>NPR2x378</b>	(2)-14" MINIMUM	R= RIGHT, L=LEFT	3	(2) 27" DOORS, (1) 24" DOOR	92	24	19.80	(2)1/4-R290	115/60/1	5.8	5-15P	862
<b>NPR2x381</b>	(2)-14" MINIMUM	R= RIGHT, L=LEFT	3	(3) 27" DOORS	95	26	20.73	(2)1/4-R290	115/60/1	5.8	5-15P	883

\*Additional length added to compressor housing.

NPR2L484

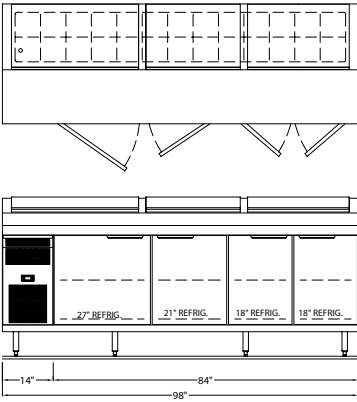

NPR2L487

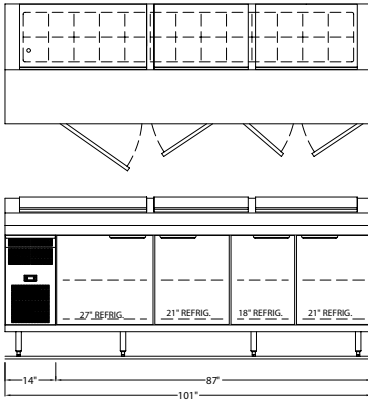

NPR2L490

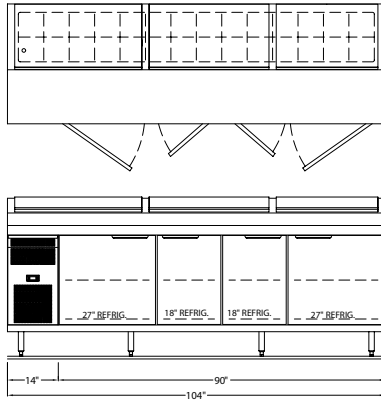

NPR2L493

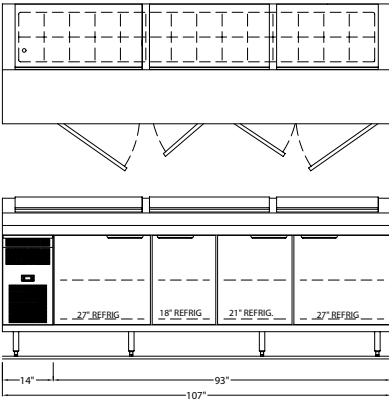

NPR2L496

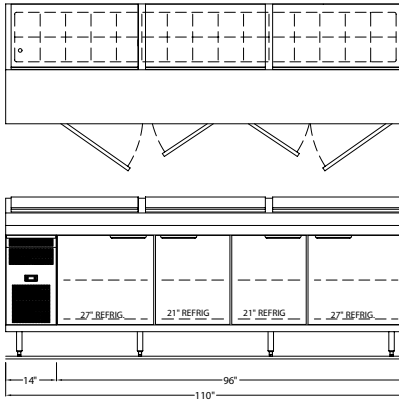

NPR2L499

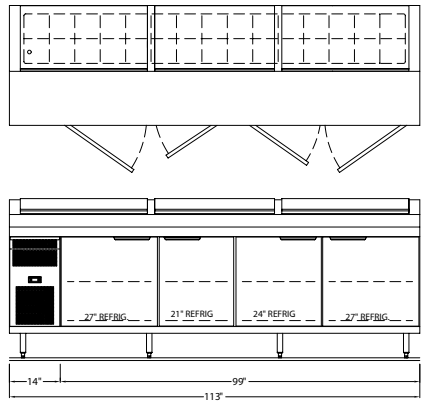

NPR2L4102

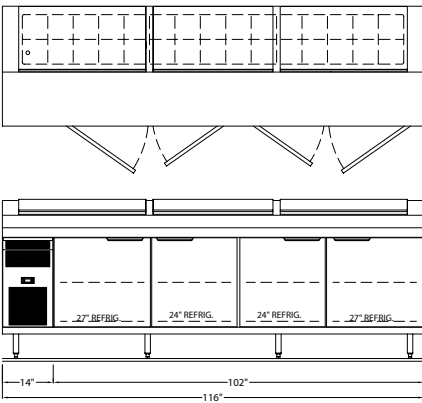

NPR2L4105

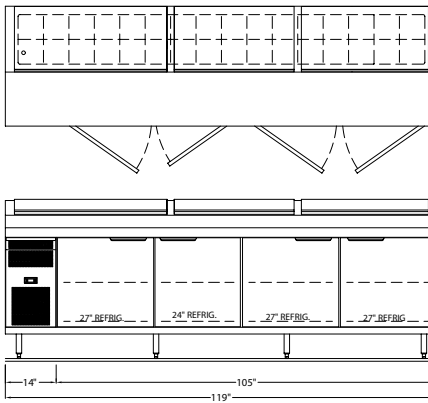

NPR2L4108

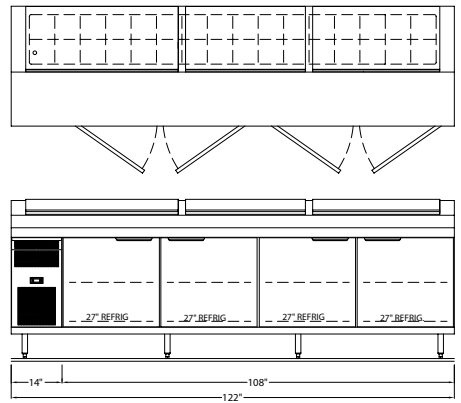

All drawings shown with compressor left (NPRxL) version of unit; compressor right model (NPRxR) is mirrored. Section sizes and locations may be adjusted within the footprint of the model.

MODEL	COMPRESSOR		BASE SECTION(S)	STANDARD REF. BASE CONFIGURATION	MIN. UNIT LENGTH*	PAN RAIL CAPACITY 1/6 SIZE PAN	BASE STORAGE CUBIC FT/ DRAWER CAPACITY	H.P./ REFRIGERANT	VOLT/ CYCLE/ PHASE	AMPS	NEMA PLUG	SHIP WT.
	QTY/COMP. HSG SIZE	LOCATION "x"										
<b>4 SECTION BASE STORAGE-SELF CONTAINED REFRIGERATORS WITH NARROW DEPTH RAISED RAIL</b>												
<b>NPR2x484</b>	(2)-14" MINIMUM	R= RIGHT, L=LEFT	4	(2) 18" DOORS, (1) 21" DOOR, (1) 27" DOOR	98	26	20.19	(2)1/4-R290	115/60/1	5.8	5-15P	904
<b>NPR2x487</b>	(2)-14" MINIMUM	R= RIGHT, L=LEFT	4	(2) 21" DOORS, (1) 18" DOOR, (1) 27" DOOR	101	26	21.12	(2)1/4-R290	115/60/1	5.8	5-15P	925
<b>NPR2x490</b>	(2)-14" MINIMUM	R= RIGHT, L=LEFT	4	(2) 27" DOORS, (2) 18" DOORS	104	28	22.05	(2)1/4-R290	115/60/1	5.8	5-15P	946
<b>NPR2x493</b>	(2)-14" MINIMUM	R= RIGHT, L=LEFT	4	(2) 27" DOORS, (1) 21" DOOR, (1) 18" DOOR	107	28	22.98	(2)1/4-R290	115/60/1	5.8	5-15P	967
<b>NPR2x496</b>	(2)-14" MINIMUM	R= RIGHT, L=LEFT	4	(2) 27" DOORS, (2) 21" DOORS	110	30	23.91	(2)1/4-R290	115/60/1	5.8	5-15P	988
<b>NPR2x499</b>	(2)-14" MINIMUM	R= RIGHT, L=LEFT	4	(2) 27" DOORS, (1) 24" DOOR, (1) 21" DOOR	113	30	24.84	(2)1/4-R290	115/60/1	5.8	5-15P	1009
<b>NPR2x4102</b>	(2)-14" MINIMUM	R= RIGHT, L=LEFT	4	(2) 27" DOORS, (2) 24" DOORS	116	30	25.78	(2)1/4-R290	115/60/1	5.8	5-15P	1030
<b>NPR2x4105</b>	(2)-14" MINIMUM	R= RIGHT, L=LEFT	4	(3) 27" DOORS, (1) 24" DOOR	119	32	26.71	(2)1/4-R290	115/60/1	5.8	5-15P	1051
<b>NPR2x4108</b>	(2)-14" MINIMUM	R= RIGHT, L=LEFT	4	(4) 27" DOORS	122	32	27.64	(2)1/4-R290	115/60/1	5.8	5-15P	1072

\*Additional length added to compressor housing.



**DOORS:**

DOOR OPENING SIZES	CLEARANCES THROUGH DOOR		INTERIOR DEPTH BEHIND DOOR	ACCEPTS SHEET PAN SLIDES	OPTIONAL DRAWER PAN CAPACITY (PER DRAWER)
	DOOR WIDTH	LT. TO RT.	TOP TO BOTTOM		
18"	13 1/4"	20 1/4"	26.5"	No	N/A
21"	16 1/4"	20 1/4"	26.5"	No	(1) 12"x20"x6"
24"	19 1/4"	20 1/4"	26.5"	Yes	(1) 12"x20"x6" + (3) 1/9
27"	22 1/4"	20 1/4"	26.5"	Yes	(2) 12"x20"x6"

\*Shelf depth is 25-1/4" on 33" deep equipment.

**OPTIONAL DRAWERS:**

21" Drawer:

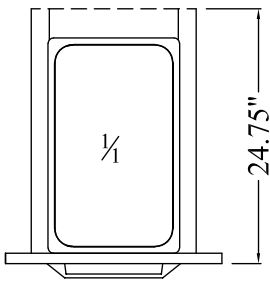

24" Drawer:

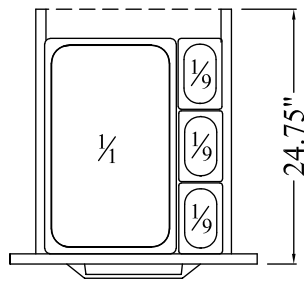

27" Drawer:

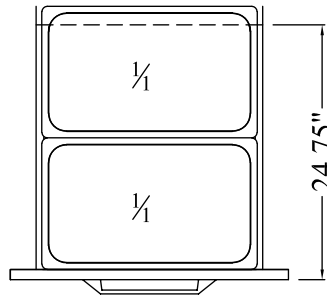

32" Drawer:

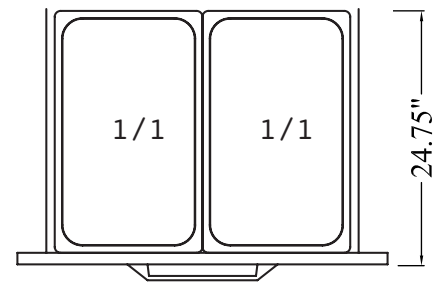

**DIMENSIONAL DETAIL:**

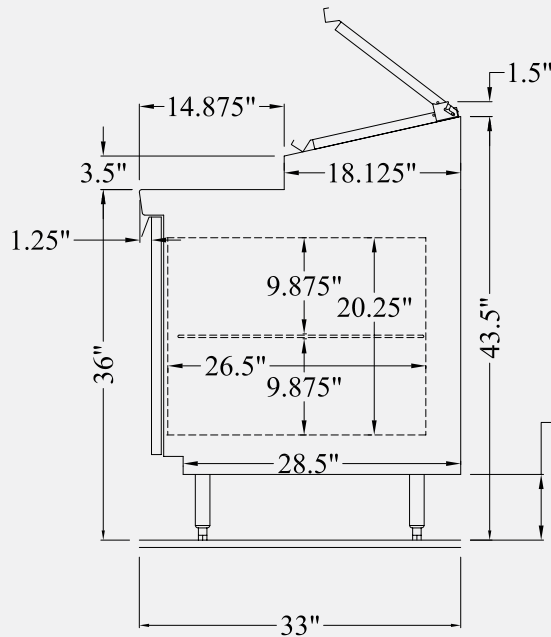

LEGS ADJUSTABLE FROM: 6" - 7.125" SHOWN @ 6.75"

Stainless Steel Finished End:

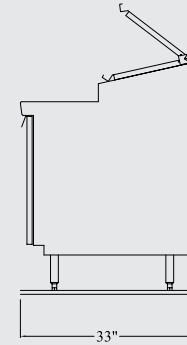

Unfinished End:

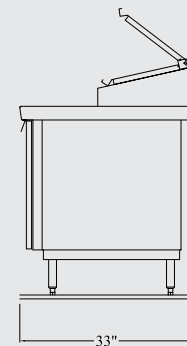

**OPTIONAL ACCESSORIES:**



See-Thru Covers



Pull-Out Shelves



Pizza Preparation Racks  
With Pull-Out Catch Pans



Drawers



Removable Pan Slides



Hood Style Cover

**OPTIONAL COVERS:**

Hinged Cover (standard):

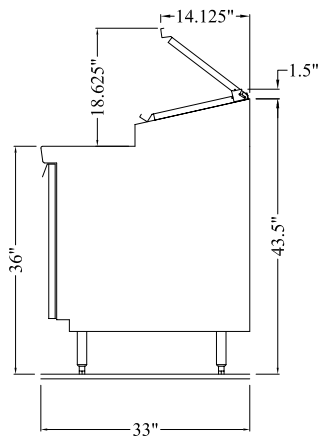

Hinged Slide-Back Cover:

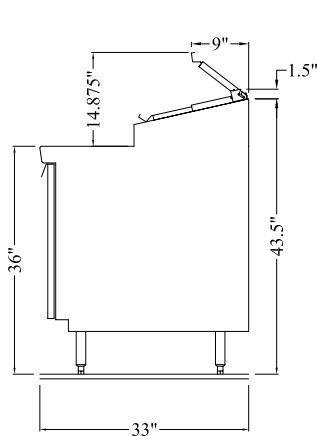

Lift-Off Cover:

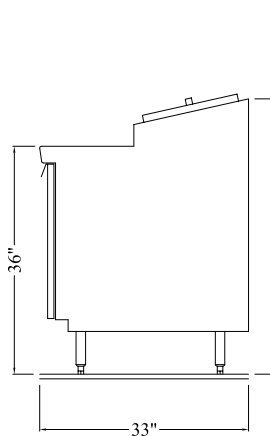

Hood Cover:

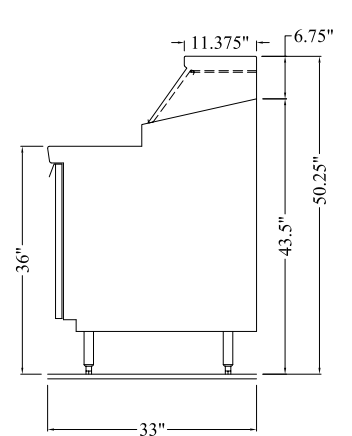

\*Units shown with optional stainless steel end panels.