



# PREP STATIONS

## SPECIALTY CUSTOM SELF-CONTAINED RAISED COLDWALL REFRIGERATOR MODELS WPR

Self-contained refrigerator storage unit with mechanically cooled raised rail. Cold-wall conductive cooled low profile raised rail w/ recessed pan ledge provides easy reach and cold above pans for optimal temperatures. Separate base and rail controllers give the operator precise control of the rail temperature and the ability to shut the rail off at night-conserves up to 60% of the daytime energy usage. Raised rail is standard with clean-out port valve allowing pan opening to be easily cleaned and sanitized.

**SHORT FORM SPEC:** Randell WPR series preparation table with natural R290 refrigeration system. Includes independently controlled mechanically cooled rail and refrigerated base, each controlled by their own electronic control. Single opening, raised rail to come standard with recessed pan ledge, adapter bars and oversized clean-out port for ease of cleanability. Base interior ends and door openings shall be high impact ABS plastic with coved corner stainless steel interior to form bottom, back and top of cabinet and be cooled with a blower coil located behind the mullion. Base cabinet doors to have heavy duty 16 ga. top mounted handles and include press-fit magnetic gaskets. Unit to be shipped standard on adjustable legs mounted to full length leg rails. cUL, UL, NSF.

### AVAILABLE MODELS:

#### 1 Section:

WPR1x130  
WPR1x133

#### 3 Sections:

WPR2x357  
WPR2x360

#### 2 Sections:

WPR1x236  
WPR1x239  
WPR1x242  
WPR1x245  
WPR1x248  
WPR1x251  
WPR1x254

WPR2x363  
WPR2x366  
WPR2x369  
WPR2x372  
WPR2x375  
WPR2x378  
WPR2x381

### STANDARD FEATURES:

- Cold-wall conductive cooled low profile raised rail with recessed pan ledge for easy reach and cold above pans
- Base cooled by high capacity mullion coil refrigeration system with adaptive defrost
- Independent temp control for rail and base allows precise temperature maintenance in each zone
- 100% front breathing compressor housing allows sealing to wall and curb mounting without special requirements
- Easy maintenance press-fit gaskets (removable without tools)
- Exclusive completely sealed pan rail interior with clean-out port allows pan opening to be easily cleaned and sanitized
- Hinged compressor compartment panel for access to clean-out port and condenser coil cleaning
- 6" high legs, adjustable and movable along full length leg rail
- Available up to 16' under one common assembly
- Adapter bars to accommodate a compliment of 1/6 size pans
- Interior lighting inside the base cabinet

**REFRIGERATION SYSTEM:** All models will utilize state of the art, energy efficient R290 compressor systems with (0) ozone depletion (ODP) and (3) global warming potential (GWP). The pan rail is conductively cooled by coldwall wrapped tank utilizing Randell's exclusive aluminum cold transfer plates to maximum heat removal capacity. Independently controlled rail and base temperatures are managed by electronic controllers metered using capillary tube systems. Independent rail control (separate from the base cabinet temperature control) allows the operator precise control of the rail and the ability to shut the rail off at night for

energy savings up to 60% of the daytime usage. Independent base control featuring adaptive defrost allows precise control of the base cabinet.

**CABINET EXTERIOR:** Top to be one piece of die-formed 16 gauge stainless steel with 2 1/2" nosing. Ends at top fitted with recessed heavy duty steel bars for field bolting units together, producing a hairline seam. Hinged louver panel to be stainless steel. Exterior body to be corrosion resistant steel. Door opening frames are ABS and contain magnetic strip for positive seal of door gaskets. Work surface to be at 36" work height. Legs to be 6" high stainless steel with adjustable bullet foot. Legs mounted to full length channel frame assembly which is integrally welded to bottom of body assembly. Legs can be moved left to right to avoid floor obstacles during installation.

**CABINET INTERIOR:** Base interior to be ABS thermoplastic at ends only. Stainless steel interior liner to be coved cornered to form bottom, back and top. One baked enamel finished shelf provided behind each door. Unit insulation to be CFC free foamed in place urethane.

**DOORS:** Door fronts to be 22-gauge stainless steel exterior front with 16 gauge stainless steel door pulls/handles. The interior liner is vacuum formed ABS with integral gasket retainer for easy cleaning and accepts Randell's Exclusive Press Fit Gasket system. Doors are mounted on concealed hinges. One removable wire shelf is supplied behind each door.



PROJECT NAME:	
LOCATION:	
ITEM NO:	
QTY:	
MODEL NO:	
AIA NO:	
SIS NO:	
CSI SECTION:	11400



Model WPR1L254 shown with stainless steel finished end, drawers and hood cover

### OPTIONS/ACCESSORIES:

#### Cabinet:

- Extra shelves
- Adjustable shelves
- Pull-out shelves (24" & 27" doors only)
- Two-tier drawers (6" deep pans)
- Triple-tier drawers (4" deep pans) (27" & 32" only)
- Tray racks for 18"x26" sheet pans (24" & 27" doors only)
- Stainless steel finished back
- Stainless steel finished ends
- Laminate fronts, ends and back
- Casters in lieu of legs
- Door/Drawer lock(s)

#### Pan Rail Covers:

- Hood cover with slide-back front
- Lift-off (removable)

#### Work-Surface:

- White poly cutting board, 1/2" or 3/4"
- Richlite cutting board, 1/2" or 3/4"

#### Additional Storage:

- Partial length pan rail
- Flat-top rail (non angled)
- Overshelfing storage options

#### Voltage:

- 220-230V/50-60Hz supplied with cord (plug provided in field by others)

### ADDITIONAL RESOURCES:

Request A Quote

Sales Tools

Find A Rep

KCL AutoCAD/Revit

WPR1L130

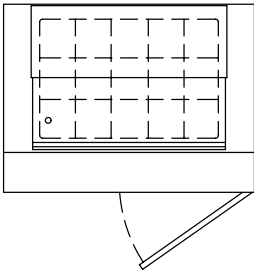

WPR1L133

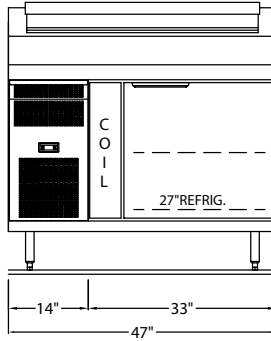
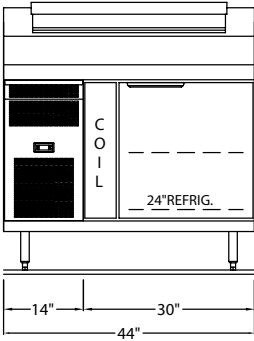
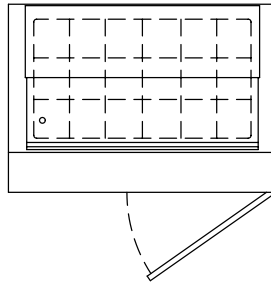

MODEL	COMPRESSOR		BASE SECTION(S)	STANDARD REF. BASE CONFIGURATION	MIN. UNIT LENGTH*	PAN RAIL CAPACITY 1/6 SIZE PAN	BASE STORAGE CUBIC FT/ DRAWER CAPACITY	H.P./ REFRIGERANT	VOLT/ CYCLE/ PHASE	AMPS	NEMA PLUG	SHIP WT.
	QTY/COMP. HSG SIZE	LOCATION "x"										
<b>1 SECTION BASE STORAGE-SELF CONTAINED REFRIGERATORS WITH WIDE DEPTH RAISED RAIL</b>												
<b>WPR1x130</b>	(1)-14" MINIMUM	R= RIGHT, L=LEFT	1	(1) 24" DOOR, 6" COIL	44	18	5.98	1/3-R290	115/60/1	6	5-15P	496
<b>WPR1x133</b>	(1)-14" MINIMUM	R= RIGHT, L=LEFT	1	(1) 27" DOOR, 6" COIL	47	18	6.91	1/3-R290	115/60/1	6	5-15P	517

\*Additional length added to compressor housing.

All drawings shown with compressor left (WPRxL) version of unit; compressor right model (WPRxR) is mirrored. Section sizes and locations may be adjusted within the footprint of the model.

WPR1L236

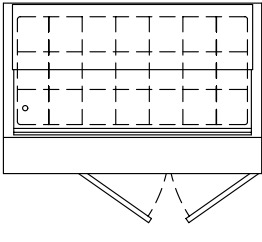

WPR1L239

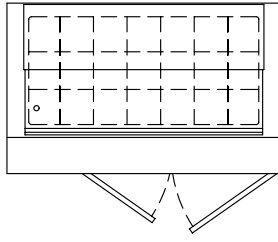

WPR1L242

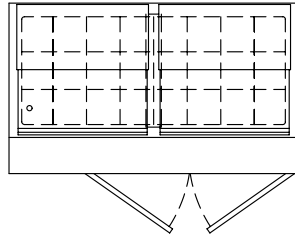

WPR1L245

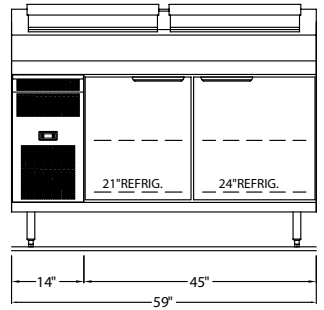
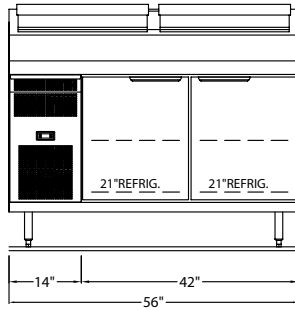
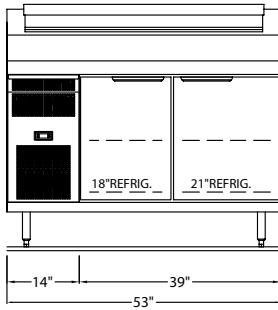
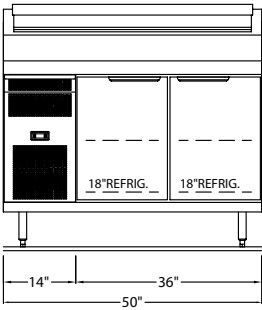
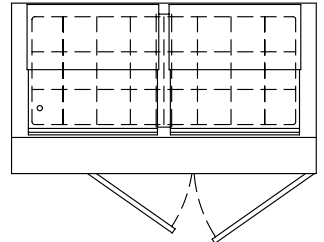

WPR1L248

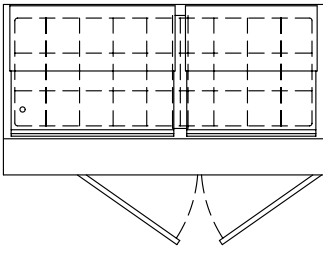

WPR1L251

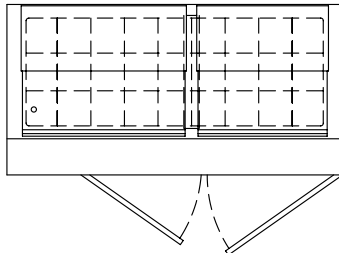

WPR1L254

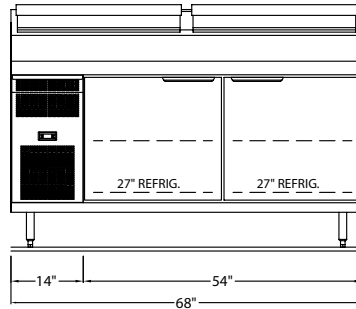
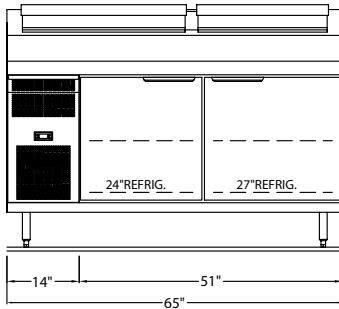
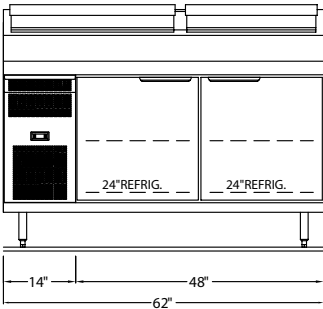
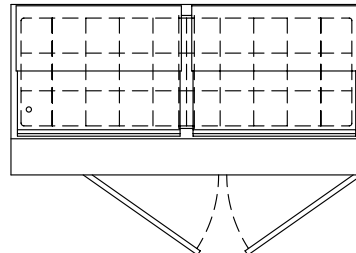

All drawings shown with compressor left (WPRxL) version of unit; compressor right model (WPRxR) is mirrored. Section sizes and locations may be adjusted within the footprint of the model.

MODEL	COMPRESSOR		BASE SECTION(S)	STANDARD REF. BASE CONFIGURATION	MIN. UNIT LENGTH*	PAN RAIL CAPACITY 1/6 SIZE PAN	BASE STORAGE CUBIC FT/ DRAWER CAPACITY	H.P./ REFRIGERANT	VOLT/ CYCLE/ PHASE	AMPS	NEMA PLUG	SHIP WT.
	QTY/COMP. HSG SIZE	LOCATION "x"										
<b>2 SECTION BASE STORAGE-SELF CONTAINED REFRIGERATORS WITH WIDE DEPTH RAISED RAIL</b>												
<b>WPR1x236</b>	(1)-14" MINIMUM	R= RIGHT, L=LEFT	2	(2) 18" DOORS	50	21	8.23	1/3-R290	115/60/1	6	5-15P	549
<b>WPR1x239</b>	(1)-14" MINIMUM	R= RIGHT, L=LEFT	2	(1) 21" DOOR, (1) 18" DOOR	53	21	9.16	1/3-R290	115/60/1	6	5-15P	571
<b>WPR1x242</b>	(1)-14" MINIMUM	R= RIGHT, L=LEFT	2	(2) 21" DOORS	56	24	10.09	1/3-R290	115/60/1	6	5-15P	593
<b>WPR1x245</b>	(1)-14" MINIMUM	R= RIGHT, L=LEFT	2	(1) 21" DOOR, (1) 24" DOOR	59	24	11.02	1/3-R290	115/60/1	6	5-15P	615
<b>WPR1x248</b>	(1)-14" MINIMUM	R= RIGHT, L=LEFT	2	(2) 24" DOORS	62	27	11.96	1/3-R290	115/60/1	6	5-15P	637
<b>WPR1x251</b>	(1)-14" MINIMUM	R= RIGHT, L=LEFT	2	(1) 24" DOOR, (1) 27" DOOR	65	27	12.89	1/3-R290	115/60/1	6	5-15P	659
<b>WPR1x254</b>	(1)-14" MINIMUM	R= RIGHT, L=LEFT	2	(2) 27" DOORS	68	30	13.82	1/3-R290	115/60/1	6	5-15P	681

\*Additional length added to compressor housing.

WPR2L357

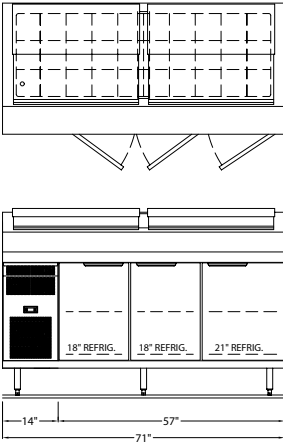

WPR2L360

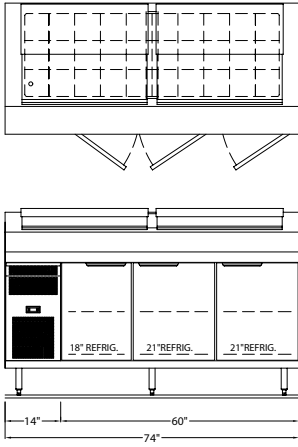

WPR2L363

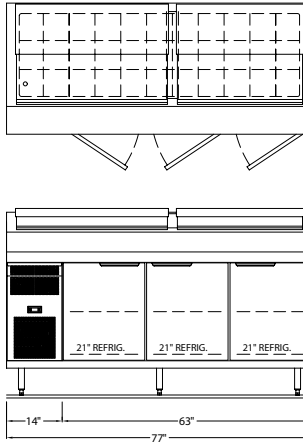

WPR2L366

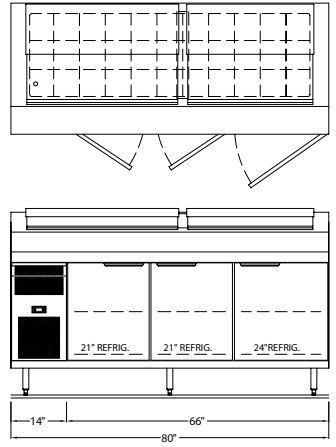

WPR2L369

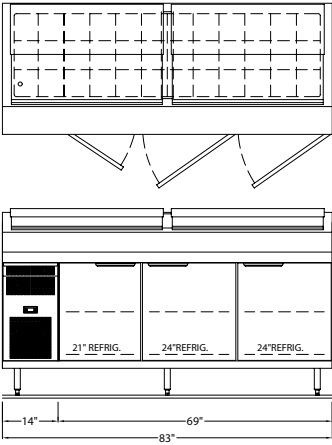

WPR2L372

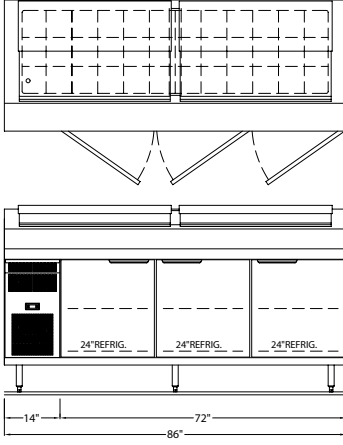

WPR2L375

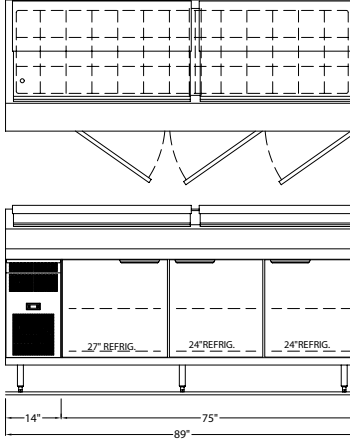

WPR2L378

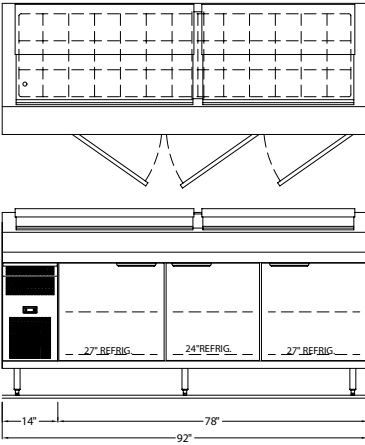

WPR2L381

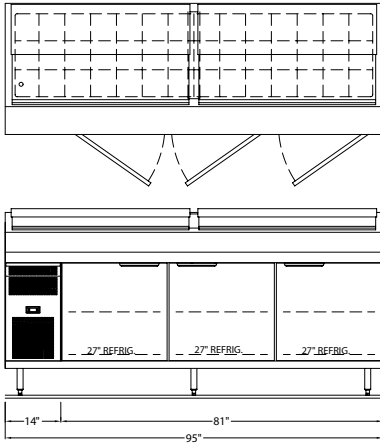

All drawings shown with compressor left (WPRxL) version of unit; compressor right model (WPRxR) is mirrored. Section sizes and locations may be adjusted within the footprint of the model.

MODEL	COMPRESSOR		BASE SECTION(S)	STANDARD REF. BASE CONFIGURATION	MIN. UNIT LENGTH*	PAN RAIL CAPACITY 1/6 SIZE PAN	BASE STORAGE CUBIC FT/ DRAWER CAPACITY	H.P./ REFRIGERANT	VOLT/ CYCLE/ PHASE	AMPS	NEMA PLUG	SHIP WT.
	QTY/COMP. HSG SIZE	LOCATION "x"										
<b>3 SECTION BASE STORAGE-SELF CONTAINED REFRIGERATORS WITH WIDE DEPTH RAISED RAIL</b>												
<b>WPR2x357</b>	(2)-14" MINIMUM	R= RIGHT, L=LEFT	3	(2) 18" DOORS, (1) 21" DOOR	71	30	13.28	(2)1/4-R290	115/60/1	5.8	5-15P	729
<b>WPR2x360</b>	(2)-14" MINIMUM	R= RIGHT, L=LEFT	3	(1) 18" DOOR, (2) 21" DOORS	74	30	14.21	(2)1/4-R290	115/60/1	5.8	5-15P	751
<b>WPR2x363</b>	(2)-14" MINIMUM	R= RIGHT, L=LEFT	3	(3) 21" DOORS	77	33	15.14	(2)1/4-R290	115/60/1	5.8	5-15P	773
<b>WPR2x366</b>	(2)-14" MINIMUM	R= RIGHT, L=LEFT	3	(2) 21" DOORS, (1) 24" DOOR	80	33	16.07	(2)1/4-R290	115/60/1	5.8	5-15P	795
<b>WPR2x369</b>	(2)-14" MINIMUM	R= RIGHT, L=LEFT	3	(1) 21" DOOR, (2) 24" DOORS	83	36	17.00	(2)1/4-R290	115/60/1	5.8	5-15P	817
<b>WPR2x372</b>	(2)-14" MINIMUM	R= RIGHT, L=LEFT	3	(3) 24" DOORS	86	36	17.93	(2)1/4-R290	115/60/1	5.8	5-15P	839
<b>WPR2x375</b>	(2)-14" MINIMUM	R= RIGHT, L=LEFT	3	(1) 27" DOOR, (2) 24" DOORS	89	39	18.87	(2)1/4-R290	115/60/1	5.8	5-15P	861
<b>WPR2x378</b>	(2)-14" MINIMUM	R= RIGHT, L=LEFT	3	(2) 27" DOORS, (1) 24" DOOR	92	39	19.80	(2)1/4-R290	115/60/1	5.8	5-15P	883
<b>WPR2x381</b>	(2)-14" MINIMUM	R= RIGHT, L=LEFT	3	(3) 27" DOORS	95	42	20.73	(2)1/4-R290	115/60/1	5.8	5-15P	905

\*Additional length added to compressor housing.

**DOORS:**

DOOR OPENING SIZES	CLEARANCES THROUGH DOOR		INTERIOR DEPTH BEHIND DOOR	ACCEPTS SHEET PAN SLIDES	OPTIONAL DRAWER PAN CAPACITY (PER DRAWER)
	DOOR WIDTH	LT. TO RT.	TOP TO BOTTOM		
18"	13 1/4"	20 1/4"	26.5"	No	N/A
21"	16 1/4"	20 1/4"	26.5"	No	(1) 12"x20"x6"
24"	19 1/4"	20 1/4"	26.5"	Yes	(1) 12"x20"x6" + (3) 1/9
27"	22 1/4"	20 1/4"	26.5"	Yes	(2) 12"x20"x6"

\*Shelf depth is 25-1/4" on 33" deep equipment.

**OPTIONAL DRAWERS:**

21" Drawer:

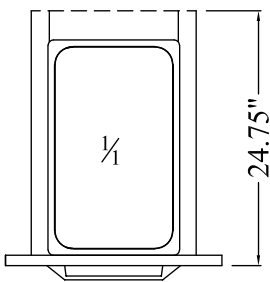

24" Drawer:

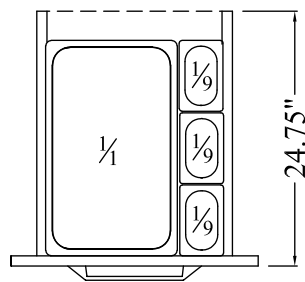

27" Drawer:

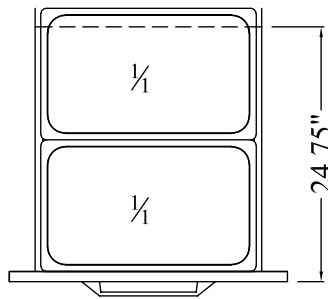

32" Drawer:

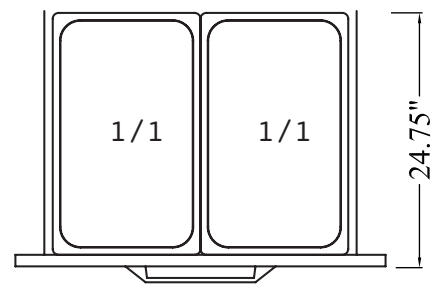

**DIMENSIONAL DETAIL:**

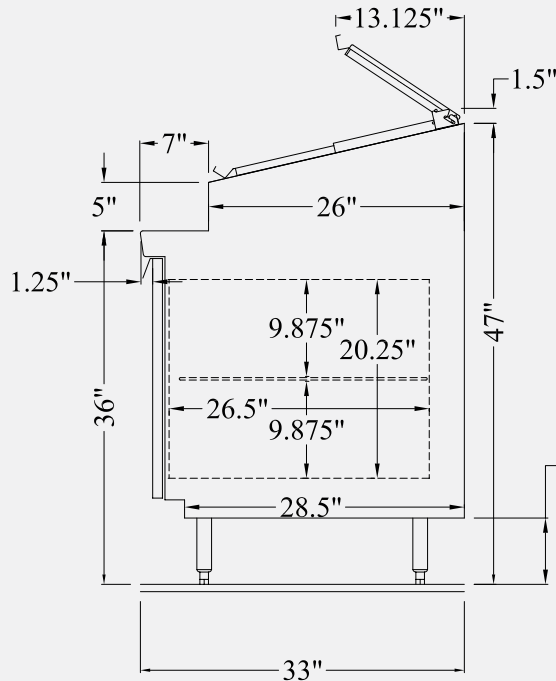

LEGS ADJUSTABLE FROM: 6" - 7.125" SHOWN @ 6.75"

Stainless Steel Finished End:

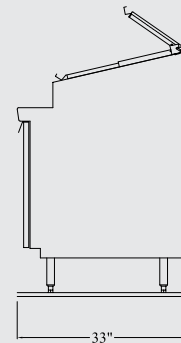

Unfinished End:

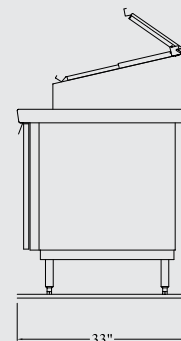

**OPTIONAL ACCESSORIES:**



Drawers



Pull-Out Shelves



Hood Style Cover



Removable Pan Slides

**OPTIONAL COVERS:**

Hinged Slide-Back Cover (standard):

Lift-Off Cover:

Hood Cover:

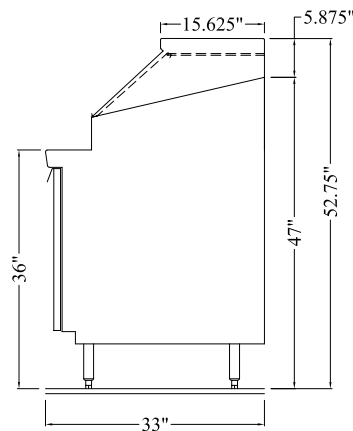
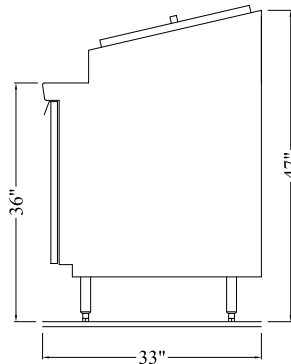
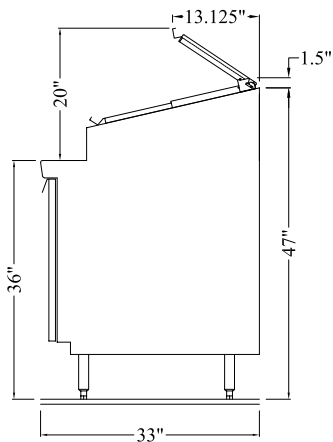

\*Units shown with optional stainless steel end panels.