



PREP STATIONS

SPECIALTY CUSTOM SELF-CONTAINED RECESSED COLDWALL REFRIGERATOR MODELS WPO

Self-contained refrigerator storage unit with mechanically cooled pan opening. Cold-wall conductive cooled pan opening with recessed pan ledge provides easy reach and cold above pans for optimal temperatures. Separate base and pan opening controllers give the operator precise control of the temperature in each zone and the ability to shut the pan opening off at night-conserves up to 60% of the daytime energy usage. Standard clean-out port allows pan opening to be easily cleaned and sanitized.

SHORT FORM SPEC: Randell WPO series preparation table with natural R290 refrigeration system. Includes independently controlled mechanically cooled pan opening and refrigerated base, each controlled by their own electronic control. Single pan opening to come standard with recessed pan ledge, adapter bars and oversized clean-out port for ease of cleanability. Base interior ends and door openings shall be high impact ABS plastic with coved corner stainless steel interior to form bottom, back and top of cabinet and be cooled with a blower coil located behind the mullion. Base cabinet doors to have heavy duty 16 ga. top mounted handles and include press-fit magnetic gaskets. Unit to be shipped standard on adjustable legs mounted to full length leg rails. cUL, UL, NSF.

AVAILABLE MODELS:

1 Section:

WPO1x130
WPO1x133

2 Sections:

WPO1x236
WPO1x239
WPO1x242
WPO1x245
WPO1x248
WPO1x251
WPO1x254

3 Sections:

WPO2x357
WPO2x360
WPO2x363
WPO2x366
WPO2x369
WPO2x372
WPO2x375
WPO2x378
WPO2x381

STANDARD FEATURES:

- Cold-wall conductive cooled pan opening with recessed pan ledge for easy reach and cold above pans
- Base cooled by high capacity mullion coil refrigeration system with adaptive defrost
- Independent temp control for pan opening and base allows precise temperature maintenance in each zone
- 100% front breathing compressor housing allows sealing to wall and curb mounting without special requirements
- Easy maintenance press-fit gaskets (removable without tools)
- Exclusive completely sealed pan opening interior with clean-out port allows pan opening to be easily cleaned and sanitized
- Hinged compressor compartment panel for access to clean-out port and condenser coil cleaning
- 6" high legs, adjustable and movable along full length leg rail
- Available up to 16' under one common assembly
- Adapter bars to accommodate a compliment of 1/6 size pans

REFRIGERATION SYSTEM: All models will utilize state of the art, energy efficient R290 compressor systems with (0) ozone depletion (ODP) and (3) global warming potential (GWP). The pan opening is conductively cooled by coldwall wrapped tank utilizing Randell's exclusive aluminum cold transfer plates to maximize heat removal capacity. Independently controlled pan opening and base temperatures are managed by electronic controllers metered using capillary tube systems. Independent pan opening control (separate

from the base cabinet temperature control) allows the operator precise control of the temperature in each zone and the ability to shut the pan opening off at night for energy savings up to 60% of the daytime usage. Independent base control featuring adaptive defrost allows precise control of the base cabinet.

CABINET EXTERIOR: Top to be one piece of die-formed 16 gauge stainless steel with 2 1/2" nosing. Ends at top fitted with recessed heavy duty steel bars for field bolting units together, producing a hairline seam. Hinged louver panel to be stainless steel. Exterior body to be corrosion resistant steel. Door opening frames are ABS and contain magnetic strip for positive seal of door gaskets. Work surface to be at 36" work height. Legs to be 6" high stainless steel with adjustable bullet foot. Legs mounted to full length channel frame assembly which is integrally welded to bottom of body assembly. Legs can be moved left to right to avoid floor obstacles during installation.

CABINET INTERIOR: Base interior to be ABS thermoplastic at ends only. Stainless steel interior liner to be coved cornered to form bottom, back and top. Unit insulation to be CFC free foamed in place urethane.

DOORS: Door fronts to be 22-gauge stainless steel exterior front with 16 gauge stainless steel door pulls/handles. The interior liner is vacuum formed ABS with integral gasket retainer for easy cleaning and accepts Randell's Exclusive Press Fit Gasket system. Doors are mounted on concealed hinges.



PROJECT NAME:	
LOCATION:	
ITEM NO:	
QTY:	
MODEL NO:	
AIA NO:	
SIS NO:	
CSI SECTION:	11400

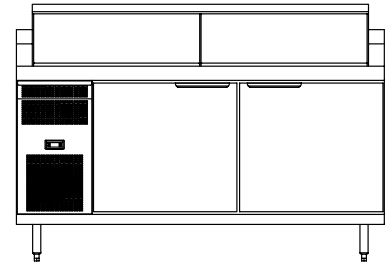

Model WPO1L254 shown

OPTIONS/ACCESSORIES:

Cabinet:

- Remove backsplash
- Intermediate shelves
- Adjustable shelves
- Stainless steel finished back
- Stainless steel finished ends
- Laminate fronts, ends and back
- Casters in lieu of legs
- Door lock(s)

Pan Opening Covers:

- Lift-off (removable)
- Hinged slide-back cover *(requires backsplash removed on 33" deep units)

Work-Surface:

- White poly cutting board, 1/2" or 3/4"
- Richlite cutting board, 1/2" or 3/4"

Additional Storage:

- Partial length pan opening
- Overshelfing storage options

Voltage:

- 220-230V/50-60Hz supplied with cord (plug provided in field by others)

ADDITIONAL RESOURCES:

- [Request A Quote](#)
- [Sales Tools](#)
- [Find A Rep](#)

WPO1L130

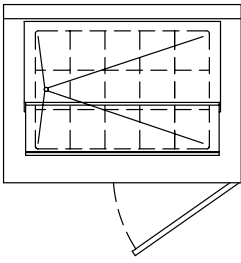

WPO1L133

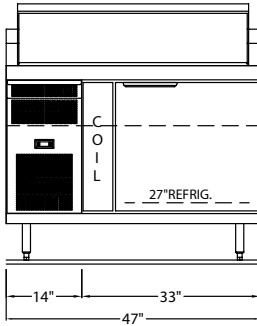
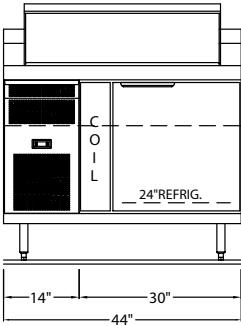
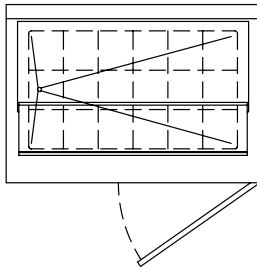

MODEL	COMPRESSOR		BASE SECTION(S)	STANDARD REF. BASE CONFIGURATION	MIN. UNIT LENGTH*	PAN OPENING CAPACITY 1/6 SIZE PAN	BASE STORAGE CUBIC FT/ DRAWER CAPACITY	H.P./ REFRIGERANT	VOLT/ CYCLE/ PHASE	AMPS	NEMA PLUG	SHIP WT.
	QTY/COMP. HSG SIZE	LOCATION "x"										
1 SECTION BASE STORAGE-SELF CONTAINED REFRIGERATORS WITH WIDE DEPTH FLAT OPENING												
WPO1x130	(1)-14" MINIMUM	R= RIGHT, L=LEFT	1	(1) 24" DOOR, 6" COIL	44	15	4.13	1/3-R290	115/60/1	6	5-15P	496
WPO1x133	(1)-14" MINIMUM	R= RIGHT, L=LEFT	1	(1) 27" DOOR, 6" COIL	47	18	4.78	1/3-R290	115/60/1	6	5-15P	517

*Additional length added to compressor housing.

All drawings shown with compressor left (WPOxL) version of unit; compressor right model (WPOxR) is mirrored. Section sizes and locations may be adjusted within the footprint of the model.

WPO1L236

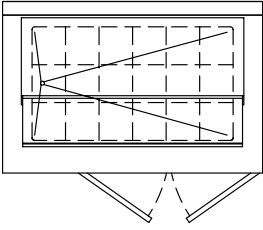

WPO1L239

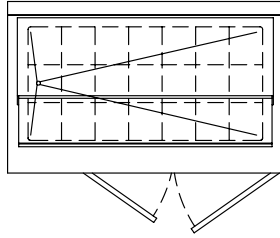

WPO1L242

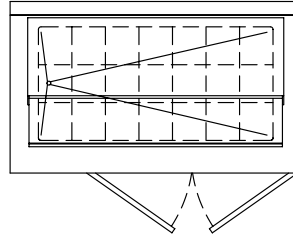

WPO1L245

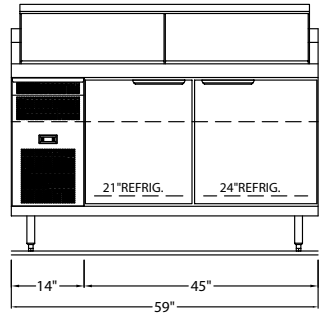
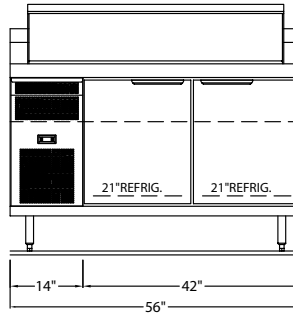
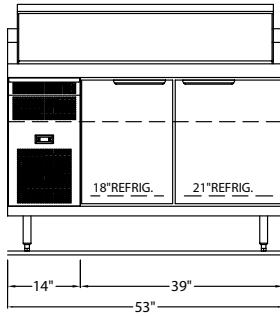
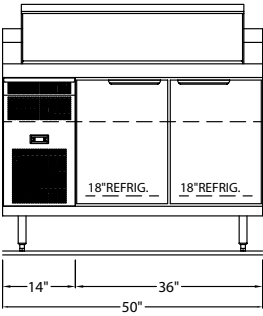
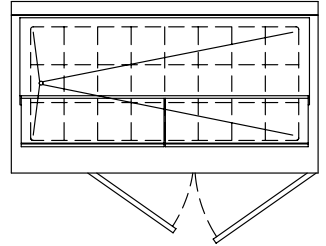

WPO1L248

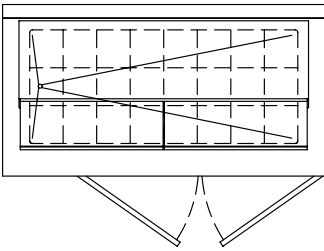

WPO1L251

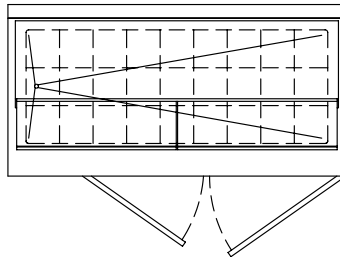

WPO1L254

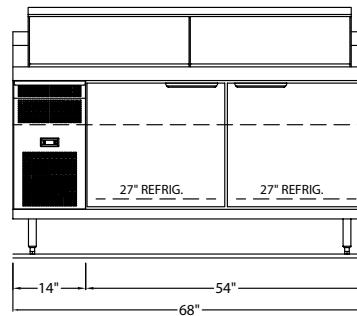
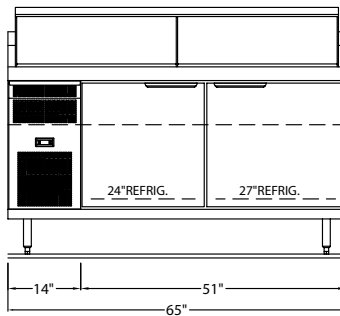
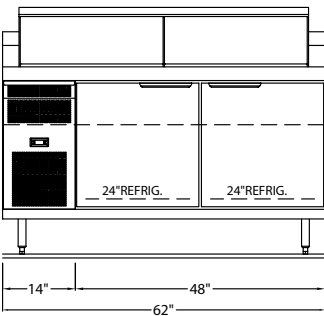
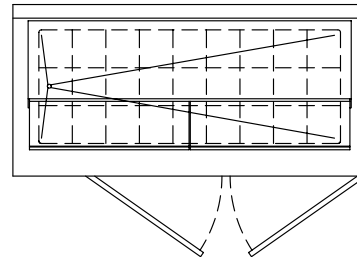

All drawings shown with compressor left (WPOxL) version of unit; compressor right model (WPOxR) is mirrored. Section sizes and locations may be adjusted within the footprint of the model.

MODEL	COMPRESSOR		BASE SECTION(S)	STANDARD REF. BASE CONFIGURATION	MIN. UNIT LENGTH*	PAN OPENING CAPACITY 1/6 SIZE PAN	BASE STORAGE CUBIC FT/ DRAWER CAPACITY	H.P./ REFRIGERANT	VOLT/ CYCLE/ PHASE	AMPS	NEMA PLUG	SHIP WT.
	QTY/COMP. HSG SIZE	LOCATION "x"										
2 SECTION BASE STORAGE-SELF CONTAINED REFRIGERATORS WITH WIDE DEPTH FLAT OPENING												
WPO1x236	(1)-14" MINIMUM	R= RIGHT, L=LEFT	2	(2) 18" DOORS	50	18	5.69	1/3-R290	115/60/1	6	5-15P	549
WPO1x239	(1)-14" MINIMUM	R= RIGHT, L=LEFT	2	(1) 21" DOOR, (1) 18" DOOR	53	21	6.33	1/3-R290	115/60/1	6	5-15P	571
WPO1x242	(1)-14" MINIMUM	R= RIGHT, L=LEFT	2	(2) 21" DOORS	56	21	6.98	1/3-R290	115/60/1	6	5-15P	593
WPO1x245	(1)-14" MINIMUM	R= RIGHT, L=LEFT	2	(1) 21" DOOR, (1) 24" DOOR	59	24	7.62	1/3-R290	115/60/1	6	5-15P	615
WPO1x248	(1)-14" MINIMUM	R= RIGHT, L=LEFT	2	(2) 24" DOORS	62	24	8.27	1/3-R290	115/60/1	6	5-15P	637
WPO1x251	(1)-14" MINIMUM	R= RIGHT, L=LEFT	2	(1) 24" DOOR, (1) 27" DOOR	65	27	8.91	1/3-R290	115/60/1	6	5-15P	659
WPO1x254	(1)-14" MINIMUM	R= RIGHT, L=LEFT	2	(2) 27" DOORS	68	27	9.55	1/3-R290	115/60/1	6	5-15P	681

*Additional length added to compressor housing.

WPO2L357

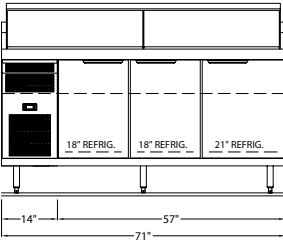
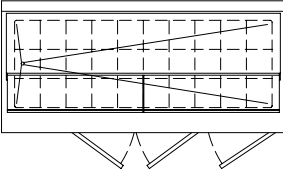

WPO2L360

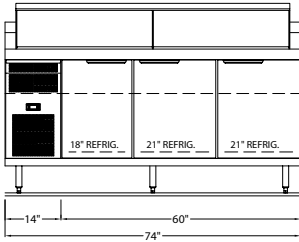
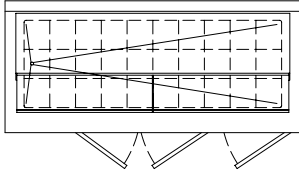

WPO2L363

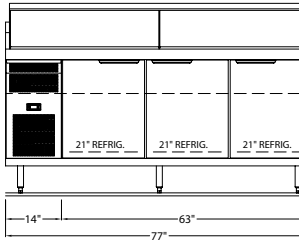
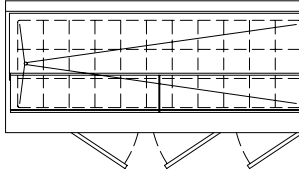

WPO2L366

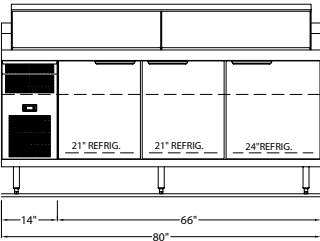
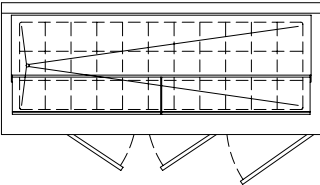

WPO2L369

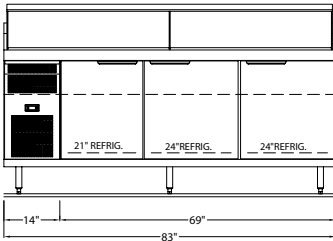
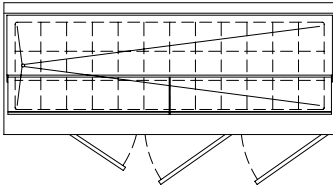

WPO2L372

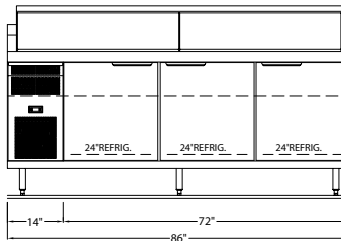
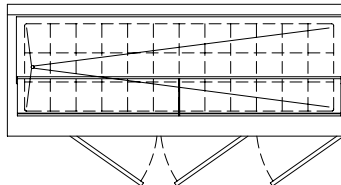

WPO2L375

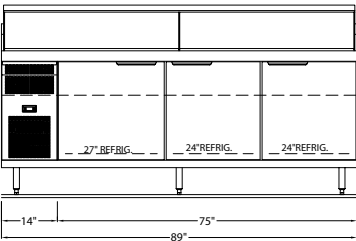
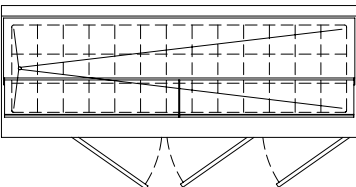

WPO2L378

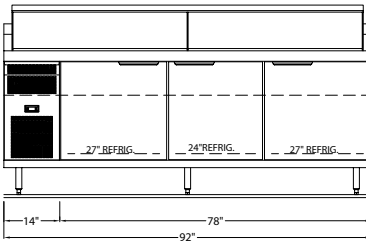
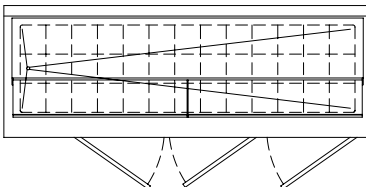

WPO2L381

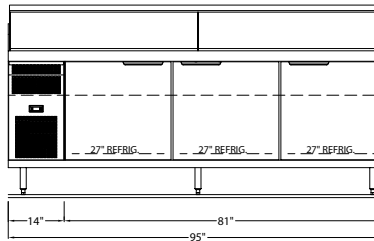
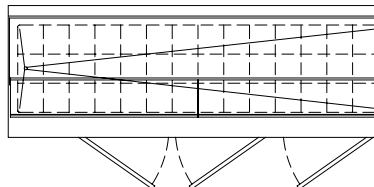

All drawings shown with compressor left (WPOxL) version of unit; compressor right model (WPOxR) is mirrored. Section sizes and locations may be adjusted within the footprint of the model.

MODEL	COMPRESSOR		BASE SECTION(S)	STANDARD REF. BASE CONFIGURATION	MIN. UNIT LENGTH*	PAN OPENING CAPACITY 1/6 SIZE PAN	BASE STORAGE CUBIC FT/ DRAWER CAPACITY	H.P./ REFRIGERANT	VOLT/ CYCLE/ PHASE	AMPS	NEMA PLUG	SHIP WT.
	QTY/COMP. HSG SIZE	LOCATION "x"										
3 SECTION BASE STORAGE-SELF CONTAINED REFRIGERATORS WITH WIDE DEPTH FLAT OPENING												
WPO2x357	(2)-14" MINIMUM	R= RIGHT, L=LEFT	3	(2) 18" DOORS, (1) 21" DOOR	71	30	9.18	(2)1/4-R290	115/60/1	5.8	5-15P	729
WPO2x360	(2)-14" MINIMUM	R= RIGHT, L=LEFT	3	(1) 18" DOOR, (2) 24" DOORS	74	30	9.82	(2)1/4-R290	115/60/1	5.8	5-15P	751
WPO2x363	(2)-14" MINIMUM	R= RIGHT, L=LEFT	3	(3) 21" DOORS	77	33	10.47	(2)1/4-R290	115/60/1	5.8	5-15P	773
WPO2x366	(2)-14" MINIMUM	R= RIGHT, L=LEFT	3	(2) 21" DOORS, (1) 24" DOOR	80	33	11.11	(2)1/4-R290	115/60/1	5.8	5-15P	795
WPO2x369	(2)-14" MINIMUM	R= RIGHT, L=LEFT	3	(1) 21" DOOR, (2) 24" DOORS	83	36	11.75	(2)1/4-R290	115/60/1	5.8	5-15P	817
WPO2x372	(2)-14" MINIMUM	R= RIGHT, L=LEFT	3	(3) 24" DOORS	86	36	12.40	(2)1/4-R290	115/60/1	5.8	5-15P	839
WPO2x375	(2)-14" MINIMUM	R= RIGHT, L=LEFT	3	(1) 27" DOOR, (2) 24" DOORS	89	39	13.04	(2)1/4-R290	115/60/1	5.8	5-15P	861
WPO2x378	(2)-14" MINIMUM	R= RIGHT, L=LEFT	3	(1) 24" DOOR, (2) 27" DOORS	92	39	13.69	(2)1/4-R290	115/60/1	5.8	5-15P	883
WPO2x381	(2)-14" MINIMUM	R= RIGHT, L=LEFT	3	(3) 27" DOORS	95	42	14.33	(2)1/4-R290	115/60/1	5.8	5-15P	905

*Additional length added to compressor housing.

DOORS:

DOOR OPENING SIZES	CLEARANCES THROUGH DOOR		INTERIOR DEPTH BEHIND DOOR	ACCEPTS SHEET PAN SLIDES
	DOOR WIDTH	LT. TO RT.	TOP TO BOTTOM	
18"	13 1/4"	14"	26.5"	No
21"	16 1/4"	14"	26.5"	No
24"	19 1/4"	14"	26.5"	Yes
27"	22 1/4"	14"	26.5"	Yes

DIMENSIONAL DETAIL:

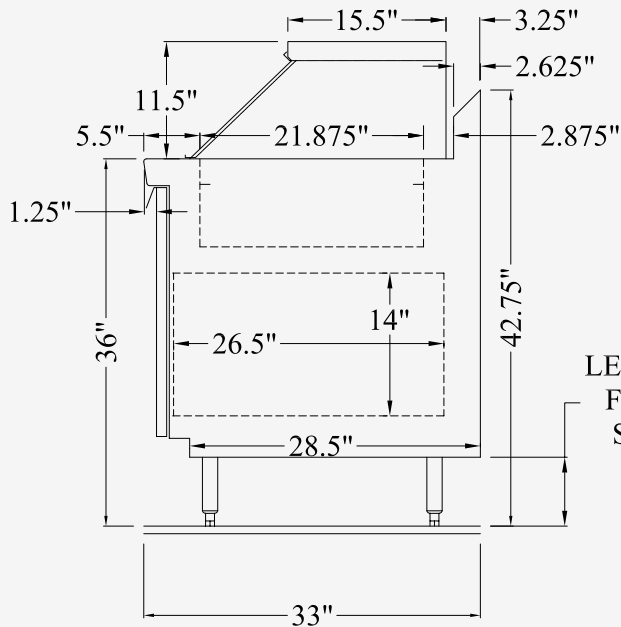

LEGS ADJUSTABLE
FROM: 6" - 7.125"
SHOWN @ 6.75"

Stainless Steel Finished End:

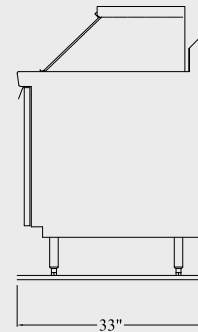

Unfinished End:

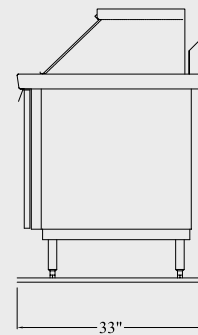

OPTIONAL COVERS:

Hood Cover (standard):

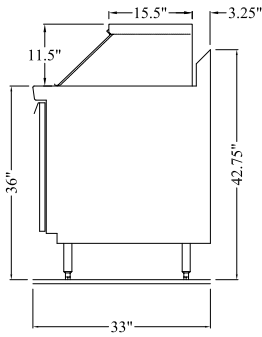

Hinged Slide-Back Cover:**

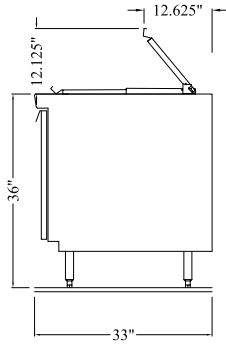

Lift-Off Cover:

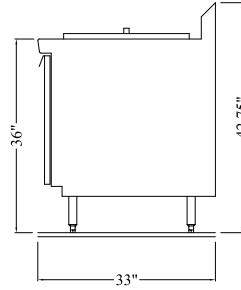

*Units shown with optional stainless steel end panels.

** Only available with backsplash removed on 33" deep units.