



CHEF SERVICE COUNTER

CUSTOM SELF-CONTAINED WORKTOP REFRIGERATOR

MODELS 51000-290

Self-contained worktop refrigerator with 16 gauge reinforced stainless steel top, and integral backsplash. Electronically controlled natural R290 refrigeration system with Randell mullion blower coil. Stainless steel doors on concealed hinges, foamed in place urethane insulation, condensate evaporator, 6" high adjustable legs and cordset for 115V operation.

SHORT FORM SPEC: Randell 51000-290 series model worktop refrigerator base with self-contained refrigeration system. Top to be 1 piece die formed stainless steel with corrosion resistant exterior body. Includes Randell evaporator blower coil fitted to base. Base interior ends and door openings shall be high impact ABS plastic with covered corner stainless steel interior to form bottom, back and top of cabinet. Base cabinet door to have ABS liner and include press-fit magnetic gaskets for positive sealing to ABS formed door opening frame. Unit to be shipped on standard 6" adjustable legs mounted to full length channel frame assembly allowing movement of legs to avoid floor obstacles. cUL, UL, NSF.

AVAILABLE MODELS:

- 51347-290
- 51362-290
- 51368-290
- 51386-290
- 51395-290

STANDARD FEATURES:

- Available under one piece top with other modular equipment up to 16' in length
- 6" high legs—adjustable and movable
- Foamed in place "CFC free" urethane insulation
- Side mounted compressor with mullion coil provides balanced cooling throughout the interior space
- SNAP compliant R-290 HC refrigerant
- Automatic condensate evaporator
- 45° integral stainless backsplash is standard. 90° stainless backsplash is optional.
- Front breathing louver design allows sealing to wall & curb mounting without special requirements
- Interior lighting inside the base cabinet

CABINET EXTERIOR: Top to be one piece of die-formed 16 gauge stainless steel with 2 1/2" nosing. Backsplash to be covered, with 45° return at top and overall height of 6 3/4". Ends at top fitted with recessed heavy duty steel bars for field bolting units together, producing a hairline seam. Hinged louver panel to be stainless steel. Exterior body to be corrosion resistant steel. Door opening frames are ABS and contain magnetic strip for positive seal of door gaskets. Work surface to be at 36" work height. Legs to be 6" high stainless steel with adjustable bullet foot. Legs mounted to full length channel frame assembly which is integrally welded to bottom of body assembly. Legs can be moved left to right to avoid floor obstacles during installation.

CABINET INTERIOR: Base interior to be ABS thermoplastic at ends only. Stainless steel interior liner to be covered corner to form bottom, back and top. One baked enamel finished shelf provided behind each door. Unit insulation to be CFC free foamed in place urethane.

DOORS: Door fronts to be 22-gauge stainless steel exterior front with 16 gauge stainless steel door pulls/handles. The interior liner is vacuum formed ABS with integral gasket retainer for easy cleaning and accepts Randell's Exclusive Press Fit Gasket system. Doors are mounted on concealed hinges. One baked enamel finished shelf provided behind each door.

REFRIGERATION: The system will utilize state of the art, energy efficient R290 compressor system with (0) ozone depletion potential (ODP) and (3) global warming potential meeting SNAP (CA) compliance. System is controlled by an externally visible electronic controller metered using capillary tube system. Front-breathing side mounted compressor housing design allows maximum airflow, heat removal and easy maintenance of the condensing unit. Mullion coil, is coated to resist corrosion, and offers balanced air flow while allowing use of the full depth interior for maximum product storage. Units totally prewired and to be supplied with 8' cordset (NEMA 5-15P) for 115V operation.



PROJECT NAME:	
LOCATION:	
ITEM NO:	
QTY:	
MODEL NO:	
AIA NO:	
SIS NO:	
CSI SECTION:	11400



51362-290 shown with optional finished end

OPTIONS/ACCESSORIES:

- Drawers
- Backsplash removed
- Tray racks for sheet pans
- Cutting boards
- Stainless Steel Ends
- Stainless Steel Back
- Laminate fronts, ends and back options
- Casters in lieu of legs
- Over-shelving storage options
- Compressor on right option
- Curb mounting
- Additional/adjustable shelves

ADDITIONAL RESOURCES:

- [Request A Quote](#)
- [Sales Tools](#)
- [Find A Rep](#)
- [KCL AutoCAD/Revit](#)

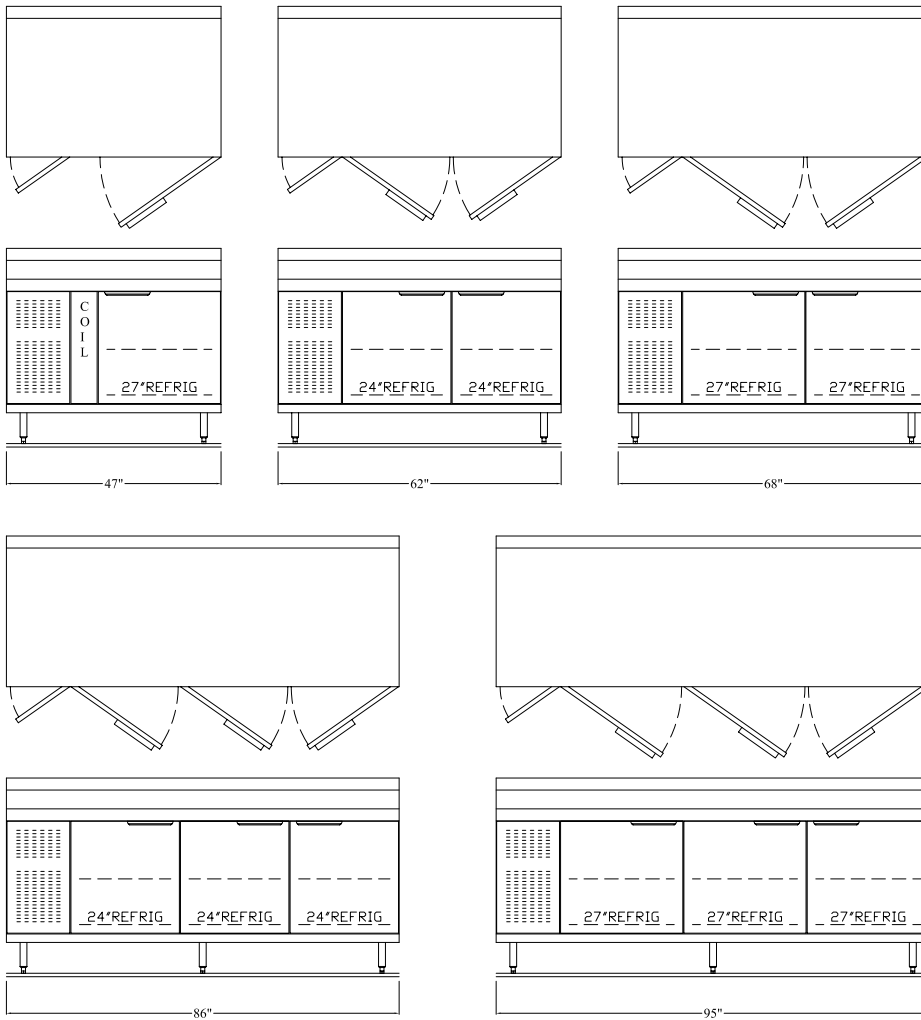
DOOR OPENING SIZE - INTERIOR DEPTH

DOOR OPENING SIZES			
DOOR WIDTH	CLEARANCES THROUGH DOOR		INTERIOR DEPTH BEHIND DOOR
	LT. TO RT.	TOP TO BTM	
24"	19.25"	20.25"	26"
27"	22.25"	20.25"	26"

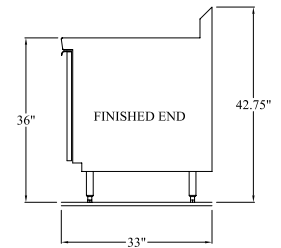
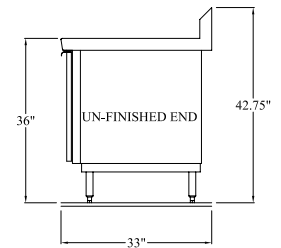

MODEL	LENGTH	DEPTH	HEIGHT	DOORS	STORAGE CU. FT.	HP	VOLT/CYCLE/ PHASE	AMPS	NEMA PLUG	SHIP WT.
51347-290	47"	33"	36"	(1) 27"	8.0	1/4	115/60/1	4.4	5-15P	410
51362-290	62"	33"	36"	(2) 24"	14.2	1/4	115/60/1	4.4	5-15P	480
51368-290	68"	33"	36"	(2) 27"	15.9	1/4	115/60/1	4.4	5-15P	540
51386-290	86"	33"	36"	(3) 24"	21.2	1/4	115/60/1	4.4	5-15P	600
51395-290	95"	33"	36"	(3) 27"	23.9	1/4	115/60/1	4.4	5-15P	660